

# T 2,5

2,5 mm

VORGEBOHRT

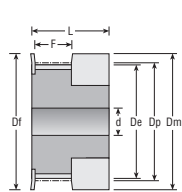

Figur 1F

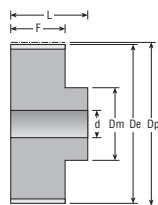

Figur 6

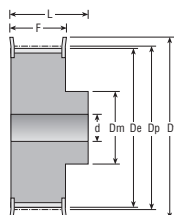

Figur 6F

| Z  | Riemenbr. | Mat. | Fig. | Best. Nr.  | De    | Df   | Dm  | F  | L  | d | Gewicht |
|----|-----------|------|------|------------|-------|------|-----|----|----|---|---------|
| 12 | 4         | AL   | 1F   | 16T2,5012N | 9,00  | 13,0 | 12  | 9  | 16 | - | 0,003   |
|    | 6         | AL   | 1F   | 16T2,5012N | 9,00  | 13,0 | 12  | 9  | 16 | - | 0,003   |
| 14 | 4         | AL   | 1F   | 16T2,5014N | 10,60 | 15,0 | 14  | 9  | 16 | - | 0,004   |
|    | 6         | AL   | 1F   | 16T2,5014N | 10,60 | 15,0 | 14  | 9  | 16 | - | 0,004   |
| 15 | 4         | AL   | 1F   | 16T2,5015N | 11,40 | 15,0 | 15  | 9  | 16 | - | 0,005   |
|    | 6         | AL   | 1F   | 16T2,5015N | 11,40 | 15,0 | 15  | 9  | 16 | - | 0,005   |
| 16 | 4         | AL   | 1F   | 16T2,5016N | 12,20 | 16,0 | 16  | 9  | 16 | - | 0,005   |
|    | 6         | AL   | 1F   | 16T2,5016N | 12,20 | 16,0 | 16  | 9  | 16 | - | 0,005   |
| 18 | 4         | AL   | 6F   | 16T2,5018N | 13,80 | 17,5 | 9,5 | 10 | 16 | 4 | 0,006   |
|    | 6         | AL   | 6F   | 16T2,5018N | 13,80 | 17,5 | 9,5 | 10 | 16 | 4 | 0,006   |
| 19 | 4         | AL   | 6F   | 16T2,5019N | 14,60 | 18,0 | 9,5 | 10 | 16 | 4 | 0,007   |
|    | 6         | AL   | 6F   | 16T2,5019N | 14,60 | 18,0 | 9,5 | 10 | 16 | 4 | 0,007   |
| 20 | 4         | AL   | 6F   | 16T2,5020N | 15,40 | 19,5 | 10  | 10 | 16 | 4 | 0,008   |
|    | 6         | AL   | 6F   | 16T2,5020N | 15,40 | 19,5 | 10  | 10 | 16 | 4 | 0,008   |
| 22 | 4         | AL   | 6F   | 16T2,5022N | 17,00 | 23,0 | 10  | 10 | 16 | 4 | 0,009   |
|    | 6         | AL   | 6F   | 16T2,5022N | 17,00 | 23,0 | 10  | 10 | 16 | 4 | 0,009   |
| 25 | 4         | AL   | 6F   | 16T2,5025N | 19,35 | 23,0 | 12  | 10 | 16 | 4 | 0,013   |
|    | 6         | AL   | 6F   | 16T2,5025N | 19,35 | 23,0 | 12  | 10 | 16 | 4 | 0,013   |
| 26 | 4         | AL   | 6F   | 16T2,5026N | 20,15 | 25,0 | 13  | 10 | 16 | 4 | 0,014   |
|    | 6         | AL   | 6F   | 16T2,5026N | 20,15 | 25,0 | 13  | 10 | 16 | 4 | 0,014   |
| 28 | 4         | AL   | 6F   | 16T2,5028N | 21,75 | 25,0 | 13  | 10 | 16 | 4 | 0,016   |
|    | 6         | AL   | 6F   | 16T2,5028N | 21,75 | 25,0 | 13  | 10 | 16 | 4 | 0,016   |
| 30 | 4         | AL   | 6F   | 16T2,5030N | 23,35 | 28,0 | 16  | 10 | 16 | 6 | 0,018   |
|    | 6         | AL   | 6F   | 16T2,5030N | 23,35 | 28,0 | 16  | 10 | 16 | 6 | 0,018   |
| 32 | 4         | AL   | 6F   | 16T2,5032N | 24,95 | 32,0 | 16  | 10 | 16 | 6 | 0,020   |
|    | 6         | AL   | 6F   | 16T2,5032N | 24,95 | 32,0 | 16  | 10 | 16 | 6 | 0,020   |
| 36 | 4         | AL   | 6F   | 16T2,5036N | 28,10 | 36,0 | 20  | 10 | 16 | 6 | 0,026   |
|    | 6         | AL   | 6F   | 16T2,5036N | 28,10 | 36,0 | 20  | 10 | 16 | 6 | 0,026   |
| 40 | 4         | AL   | 6F   | 16T2,5040N | 31,30 | 38,0 | 20  | 10 | 16 | 6 | 0,032   |
|    | 6         | AL   | 6F   | 16T2,5040N | 31,30 | 38,0 | 20  | 10 | 16 | 6 | 0,032   |
| 44 | 4         | AL   | 6F   | 16T2,5044N | 34,50 | 42,0 | 24  | 10 | 16 | 6 | 0,040   |
|    | 6         | AL   | 6F   | 16T2,5044N | 34,50 | 42,0 | 24  | 10 | 16 | 6 | 0,040   |
| 48 | 4         | AL   | 6    | 16T2,5048N | 37,70 | -    | 26  | 10 | 16 | 6 | 0,048   |
|    | 6         | AL   | 6    | 16T2,5048N | 37,70 | -    | 26  | 10 | 16 | 6 | 0,048   |
| 60 | 4         | AL   | 6    | 16T2,5060N | 47,25 | -    | 34  | 10 | 16 | 8 | 0,073   |
|    | 6         | AL   | 6    | 16T2,5060N | 47,25 | -    | 34  | 10 | 16 | 8 | 0,073   |

# T 5

## 5 mm

### VORGEBOHRT

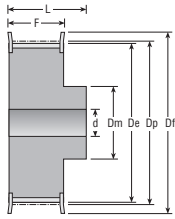

Figur 6F

| Z  | Riemenbr. | Mat. | Fig. | Best. Nr. | De    | Df   | Dm | F  | L  | d | Gewicht |
|----|-----------|------|------|-----------|-------|------|----|----|----|---|---------|
| 10 | 10        | AL   | 6F   | 21T5010N  | 15,05 | 19,5 | 8  | 15 | 21 | - | 0,012   |
|    | 16        | AL   | 6F   | 27T5010N  | 15,05 | 19,5 | 8  | 21 | 27 | - | 0,016   |
|    | 25        | AL   | 6F   | 36T5010N  | 15,05 | 19,5 | 8  | 30 | 36 | - | 0,023   |
| 12 | 10        | AL   | 6F   | 21T5012N  | 18,25 | 23,0 | 10 | 15 | 21 | - | 0,016   |
|    | 16        | AL   | 6F   | 27T5012N  | 18,25 | 23,0 | 10 | 21 | 27 | - | 0,022   |
|    | 25        | AL   | 6F   | 36T5012N  | 18,25 | 23,0 | 10 | 30 | 36 | - | 0,031   |
| 14 | 10        | AL   | 6F   | 21T5014N  | 21,45 | 25,0 | 13 | 15 | 21 | - | 0,019   |
|    | 16        | AL   | 6F   | 27T5014N  | 21,45 | 25,0 | 13 | 21 | 27 | - | 0,026   |
|    | 25        | AL   | 6F   | 36T5014N  | 21,45 | 25,0 | 13 | 30 | 36 | - | 0,037   |
| 15 | 10        | AL   | 6F   | 21T5015N  | 23,05 | 28,0 | 16 | 15 | 21 | 6 | 0,021   |
|    | 16        | AL   | 6F   | 27T5015N  | 23,05 | 28,0 | 16 | 21 | 27 | 6 | 0,029   |
|    | 25        | AL   | 6F   | 36T5015N  | 23,05 | 28,0 | 16 | 30 | 36 | 6 | 0,041   |
| 16 | 10        | AL   | 6F   | 21T5016N  | 24,60 | 32,0 | 18 | 15 | 21 | 6 | 0,025   |
|    | 16        | AL   | 6F   | 27T5016N  | 24,60 | 32,0 | 18 | 21 | 27 | 6 | 0,035   |
|    | 25        | AL   | 6F   | 36T5016N  | 24,60 | 32,0 | 18 | 30 | 36 | 6 | 0,050   |
| 18 | 10        | AL   | 6F   | 21T5018N  | 27,80 | 32,0 | 19 | 15 | 21 | 6 | 0,031   |
|    | 16        | AL   | 6F   | 27T5018N  | 27,80 | 32,0 | 19 | 21 | 27 | 6 | 0,043   |
|    | 25        | AL   | 6F   | 36T5018N  | 27,80 | 32,0 | 19 | 30 | 36 | 6 | 0,061   |
| 19 | 10        | AL   | 6F   | 21T5019N  | 29,40 | 36,0 | 22 | 15 | 21 | 6 | 0,036   |
|    | 16        | AL   | 6F   | 27T5019N  | 29,40 | 36,0 | 22 | 21 | 27 | 6 | 0,049   |
|    | 25        | AL   | 6F   | 36T5019N  | 29,40 | 36,0 | 22 | 30 | 36 | 6 | 0,070   |
| 20 | 10        | AL   | 6F   | 21T5020N  | 31,00 | 36,0 | 23 | 15 | 21 | 6 | 0,038   |
|    | 16        | AL   | 6F   | 27T5020N  | 31,00 | 36,0 | 23 | 21 | 27 | 6 | 0,053   |
|    | 25        | AL   | 6F   | 36T5020N  | 31,00 | 36,0 | 23 | 30 | 36 | 6 | 0,076   |
| 22 | 10        | AL   | 6F   | 21T5022N  | 34,25 | 38,0 | 24 | 15 | 21 | 6 | 0,046   |
|    | 16        | AL   | 6F   | 27T5022N  | 34,25 | 38,0 | 24 | 21 | 27 | 6 | 0,054   |
|    | 25        | AL   | 6F   | 36T5022N  | 34,25 | 38,0 | 24 | 30 | 36 | 6 | 0,080   |
| 24 | 10        | AL   | 6F   | 21T5024N  | 37,40 | 42,0 | 26 | 15 | 21 | 6 | 0,054   |
|    | 16        | AL   | 6F   | 27T5024N  | 37,40 | 42,0 | 26 | 21 | 27 | 6 | 0,076   |
|    | 25        | AL   | 6F   | 36T5024N  | 37,40 | 42,0 | 26 | 30 | 36 | 8 | 0,109   |
| 25 | 10        | AL   | 6F   | 21T5025N  | 39,00 | 44,0 | 26 | 15 | 21 | 6 | 0,058   |
|    | 16        | AL   | 6F   | 27T5025N  | 39,00 | 44,0 | 26 | 21 | 27 | 6 | 0,081   |
|    | 25        | AL   | 6F   | 36T5025N  | 39,00 | 44,0 | 26 | 30 | 36 | 8 | 0,116   |
| 26 | 10        | AL   | 6F   | 21T5026N  | 40,60 | 44,0 | 26 | 15 | 21 | 6 | 0,062   |
|    | 16        | AL   | 6F   | 27T5026N  | 40,60 | 44,0 | 26 | 21 | 27 | 6 | 0,085   |
|    | 25        | AL   | 6F   | 36T5026N  | 40,60 | 44,0 | 26 | 30 | 36 | 8 | 0,120   |
| 27 | 10        | AL   | 6F   | 21T5027N  | 42,20 | 48,0 | 30 | 15 | 21 | 8 | 0,064   |
|    | 16        | AL   | 6F   | 27T5027N  | 42,20 | 48,0 | 30 | 21 | 27 | 8 | 0,090   |
|    | 25        | AL   | 6F   | 36T5027N  | 42,20 | 48,0 | 30 | 30 | 36 | 8 | 0,128   |
| 28 | 10        | AL   | 6F   | 21T5028N  | 43,75 | 48,0 | 32 | 15 | 21 | 8 | 0,071   |
|    | 16        | AL   | 6F   | 27T5028N  | 43,75 | 48,0 | 32 | 21 | 27 | 8 | 0,092   |
|    | 25        | AL   | 6F   | 36T5028N  | 43,75 | 48,0 | 32 | 30 | 36 | 8 | 0,128   |
| 30 | 10        | AL   | 6F   | 21T5030N  | 46,95 | 51,0 | 34 | 15 | 21 | 8 | 0,075   |
|    | 16        | AL   | 6F   | 27T5030N  | 46,95 | 51,0 | 34 | 21 | 27 | 8 | 0,105   |
|    | 25        | AL   | 6F   | 36T5030N  | 46,95 | 51,0 | 34 | 30 | 36 | 8 | 0,150   |

# T5

5 mm

VORGEBOHRT

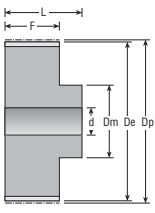

Figur 6

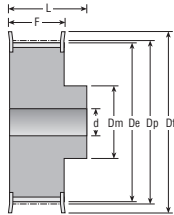

Figur 6F

| Z  | Riemenbr. | Mat. | Fig. | Best. Nr. | De    | Df   | Dm | F  | L  | d | Gewicht |
|----|-----------|------|------|-----------|-------|------|----|----|----|---|---------|
| 32 | 10        | AL   | 6F   | 21T5032N  | 50,10 | 54,0 | 38 | 15 | 21 | 8 | 0,088   |
|    | 16        | AL   | 6F   | 27T5032N  | 50,10 | 54,0 | 38 | 21 | 27 | 8 | 0,123   |
|    | 25        | AL   | 6F   | 36T5032N  | 50,10 | 54,0 | 38 | 30 | 36 | 8 | 0,176   |
| 36 | 10        | AL   | 6F   | 21T5036N  | 56,45 | 63,0 | 38 | 15 | 21 | 8 | 0,114   |
|    | 16        | AL   | 6F   | 27T5036N  | 56,45 | 63,0 | 38 | 21 | 27 | 8 | 0,160   |
|    | 25        | AL   | 6F   | 36T5036N  | 56,45 | 63,0 | 38 | 30 | 36 | 8 | 0,230   |
| 40 | 10        | AL   | 6F   | 21T5040N  | 62,85 | 66,0 | 40 | 15 | 21 | 8 | 0,138   |
|    | 16        | AL   | 6F   | 27T5040N  | 62,85 | 66,0 | 40 | 21 | 27 | 8 | 0,193   |
|    | 25        | AL   | 6F   | 36T5040N  | 62,85 | 66,0 | 40 | 30 | 36 | 8 | 0,276   |
| 42 | 10        | AL   | 6F   | 21T5042N  | 66,00 | 71,0 | 40 | 15 | 21 | 8 | 0,180   |
|    | 16        | AL   | 6F   | 27T5042N  | 66,00 | 71,0 | 40 | 21 | 27 | 8 | 0,205   |
|    | 25        | AL   | 6F   | 36T5042N  | 66,00 | 71,0 | 40 | 30 | 36 | 8 | 0,284   |
| 44 | 10        | AL   | 6    | 21T5044N  | 69,20 | -    | 45 | 15 | 21 | 8 | 0,185   |
|    | 16        | AL   | 6    | 27T5044N  | 69,20 | -    | 45 | 21 | 27 | 8 | 0,228   |
|    | 25        | AL   | 6    | 36T5044N  | 69,20 | -    | 45 | 30 | 36 | 8 | 0,315   |
| 48 | 10        | AL   | 6    | 21T5048N  | 75,55 | -    | 50 | 15 | 21 | 8 | 0,200   |
|    | 16        | AL   | 6    | 27T5048N  | 75,55 | -    | 50 | 21 | 27 | 8 | 0,280   |
|    | 25        | AL   | 6    | 36T5048N  | 75,55 | -    | 50 | 30 | 36 | 8 | 0,400   |
| 60 | 10        | AL   | 6    | 21T5060N  | 94,65 | -    | 65 | 15 | 21 | 8 | 0,307   |
|    | 16        | AL   | 6    | 27T5060N  | 94,65 | -    | 65 | 21 | 27 | 8 | 0,430   |
|    | 25        | AL   | 6    | 36T5060N  | 94,65 | -    | 65 | 30 | 36 | 8 | 0,614   |

# AT 5

5 mm

## VORGEBOHRT

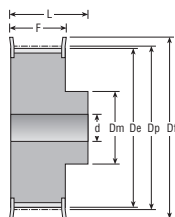

Figur 6F

| Z  | Riemenbr. | Mat. | Fig. | Best. Nr. | De    | Df   | Dm | F  | L  | d | Gewicht |
|----|-----------|------|------|-----------|-------|------|----|----|----|---|---------|
| 10 | 10        | AL   | 6F   | 21AT5010N | 14,65 | 19,5 | 8  | 15 | 21 | - | 0,012   |
|    | 16        | AL   | 6F   | 27AT5010N | 14,65 | 19,5 | 8  | 21 | 27 | - | 0,016   |
|    | 25        | AL   | 6F   | 36AT5010N | 14,65 | 19,5 | 8  | 30 | 36 | - | 0,023   |
| 12 | 10        | AL   | 6F   | 21AT5012N | 17,85 | 23,0 | 10 | 15 | 21 | - | 0,016   |
|    | 16        | AL   | 6F   | 27AT5012N | 17,85 | 23,0 | 10 | 21 | 27 | - | 0,022   |
|    | 25        | AL   | 6F   | 36AT5012N | 17,85 | 23,0 | 10 | 30 | 36 | - | 0,031   |
| 14 | 10        | AL   | 6F   | 21AT5014N | 21,05 | 25,0 | 13 | 15 | 21 | - | 0,019   |
|    | 16        | AL   | 6F   | 27AT5014N | 21,05 | 25,0 | 13 | 21 | 27 | - | 0,026   |
|    | 25        | AL   | 6F   | 36AT5014N | 21,05 | 25,0 | 13 | 30 | 36 | - | 0,037   |
| 15 | 10        | AL   | 6F   | 21AT5015N | 22,65 | 28,0 | 16 | 15 | 21 | 6 | 0,021   |
|    | 16        | AL   | 6F   | 27AT5015N | 22,65 | 28,0 | 16 | 21 | 27 | 6 | 0,029   |
|    | 25        | AL   | 6F   | 36AT5015N | 22,65 | 28,0 | 16 | 30 | 36 | 6 | 0,041   |
| 16 | 10        | AL   | 6F   | 21AT5016N | 24,20 | 32,0 | 18 | 15 | 21 | 6 | 0,025   |
|    | 16        | AL   | 6F   | 27AT5016N | 24,20 | 32,0 | 18 | 21 | 27 | 6 | 0,035   |
|    | 25        | AL   | 6F   | 36AT5016N | 24,20 | 32,0 | 18 | 30 | 36 | 6 | 0,050   |
| 18 | 10        | AL   | 6F   | 21AT5018N | 27,40 | 32,0 | 19 | 15 | 21 | 6 | 0,031   |
|    | 16        | AL   | 6F   | 27AT5018N | 27,40 | 32,0 | 19 | 21 | 27 | 6 | 0,043   |
|    | 25        | AL   | 6F   | 36AT5018N | 27,40 | 32,0 | 19 | 30 | 36 | 6 | 0,061   |
| 19 | 10        | AL   | 6F   | 21AT5019N | 29,00 | 36,0 | 22 | 15 | 21 | 6 | 0,036   |
|    | 16        | AL   | 6F   | 27AT5019N | 29,00 | 36,0 | 22 | 21 | 27 | 6 | 0,049   |
|    | 25        | AL   | 6F   | 36AT5019N | 29,00 | 36,0 | 22 | 30 | 36 | 6 | 0,070   |
| 20 | 10        | AL   | 6F   | 21AT5020N | 30,60 | 36,0 | 23 | 15 | 21 | 6 | 0,038   |
|    | 16        | AL   | 6F   | 27AT5020N | 30,60 | 36,0 | 23 | 21 | 27 | 6 | 0,053   |
|    | 25        | AL   | 6F   | 36AT5020N | 30,60 | 36,0 | 23 | 30 | 36 | 6 | 0,076   |
| 22 | 10        | AL   | 6F   | 21AT5022N | 33,85 | 38,0 | 24 | 15 | 21 | 6 | 0,046   |
|    | 16        | AL   | 6F   | 27AT5022N | 33,85 | 38,0 | 24 | 21 | 27 | 6 | 0,054   |
|    | 25        | AL   | 6F   | 36AT5022N | 33,85 | 38,0 | 24 | 30 | 36 | 6 | 0,080   |
| 24 | 10        | AL   | 6F   | 21AT5024N | 37,00 | 42,0 | 26 | 15 | 21 | 6 | 0,054   |
|    | 16        | AL   | 6F   | 27AT5024N | 37,00 | 42,0 | 26 | 21 | 27 | 6 | 0,076   |
|    | 25        | AL   | 6F   | 36AT5024N | 37,00 | 42,0 | 26 | 30 | 36 | 8 | 0,109   |
| 25 | 10        | AL   | 6F   | 21AT5025N | 38,60 | 44,0 | 26 | 15 | 21 | 6 | 0,058   |
|    | 16        | AL   | 6F   | 27AT5025N | 38,60 | 44,0 | 26 | 21 | 27 | 6 | 0,081   |
|    | 25        | AL   | 6F   | 36AT5025N | 38,60 | 44,0 | 26 | 30 | 36 | 8 | 0,116   |
| 26 | 10        | AL   | 6F   | 21AT5026N | 40,20 | 44,0 | 26 | 15 | 21 | 6 | 0,062   |
|    | 16        | AL   | 6F   | 27AT5026N | 40,20 | 44,0 | 26 | 21 | 27 | 6 | 0,085   |
|    | 25        | AL   | 6F   | 36AT5026N | 40,20 | 44,0 | 26 | 30 | 36 | 8 | 0,120   |
| 27 | 10        | AL   | 6F   | 21AT5027N | 41,80 | 48,0 | 30 | 15 | 21 | 8 | 0,064   |
|    | 16        | AL   | 6F   | 27AT5027N | 41,80 | 48,0 | 30 | 21 | 27 | 8 | 0,090   |
|    | 25        | AL   | 6F   | 36AT5027N | 41,80 | 48,0 | 30 | 30 | 36 | 8 | 0,128   |
| 28 | 10        | AL   | 6F   | 21AT5028N | 43,35 | 48,0 | 32 | 15 | 21 | 8 | 0,071   |
|    | 16        | AL   | 6F   | 27AT5028N | 43,35 | 48,0 | 32 | 21 | 27 | 8 | 0,092   |
|    | 25        | AL   | 6F   | 36AT5028N | 43,35 | 48,0 | 32 | 30 | 36 | 8 | 0,128   |
| 30 | 10        | AL   | 6F   | 21AT5030N | 46,55 | 51,0 | 34 | 15 | 21 | 8 | 0,075   |
|    | 16        | AL   | 6F   | 27AT5030N | 46,55 | 51,0 | 34 | 21 | 27 | 8 | 0,105   |
|    | 25        | AL   | 6F   | 36AT5030N | 46,55 | 51,0 | 34 | 30 | 36 | 8 | 0,150   |

# AT5

5 mm

VORGEBOHRT

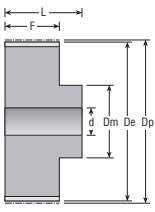

Figur 6

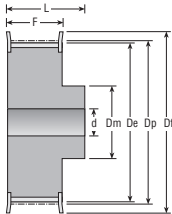

Figur 6F

| Z  | Riemenbr. | Mat. | Fig. | Best. Nr. | De    | Df   | Dm | F  | L  | d | Gewicht |
|----|-----------|------|------|-----------|-------|------|----|----|----|---|---------|
| 32 | 10        | AL   | 6F   | 21AT5032N | 49,70 | 54,0 | 38 | 15 | 21 | 8 | 0,088   |
|    | 16        | AL   | 6F   | 27AT5032N | 49,70 | 54,0 | 38 | 21 | 27 | 8 | 0,123   |
|    | 25        | AL   | 6F   | 36AT5032N | 49,70 | 54,0 | 38 | 30 | 36 | 8 | 0,176   |
| 36 | 10        | AL   | 6F   | 21AT5036N | 56,05 | 63,0 | 38 | 15 | 21 | 8 | 0,114   |
|    | 16        | AL   | 6F   | 27AT5036N | 56,05 | 63,0 | 38 | 21 | 27 | 8 | 0,160   |
|    | 25        | AL   | 6F   | 36AT5036N | 56,05 | 63,0 | 38 | 30 | 36 | 8 | 0,230   |
| 40 | 10        | AL   | 6F   | 21AT5040N | 62,45 | 66,0 | 40 | 15 | 21 | 8 | 0,138   |
|    | 16        | AL   | 6F   | 27AT5040N | 62,45 | 66,0 | 40 | 21 | 27 | 8 | 0,193   |
|    | 25        | AL   | 6F   | 36AT5040N | 62,45 | 66,0 | 40 | 30 | 36 | 8 | 0,276   |
| 42 | 10        | AL   | 6F   | 21AT5042N | 65,60 | 71,0 | 40 | 15 | 21 | 8 | 0,180   |
|    | 16        | AL   | 6F   | 27AT5042N | 65,60 | 71,0 | 40 | 21 | 27 | 8 | 0,205   |
|    | 25        | AL   | 6F   | 36AT5042N | 65,60 | 71,0 | 40 | 30 | 36 | 8 | 0,284   |
| 44 | 10        | AL   | 6    | 21AT5044N | 68,80 | -    | 45 | 15 | 21 | 8 | 0,185   |
|    | 16        | AL   | 6    | 27AT5044N | 68,80 | -    | 45 | 21 | 27 | 8 | 0,228   |
|    | 25        | AL   | 6    | 36AT5044N | 68,80 | -    | 45 | 30 | 36 | 8 | 0,315   |
| 48 | 10        | AL   | 6    | 21AT5048N | 75,15 | -    | 50 | 15 | 21 | 8 | 0,200   |
|    | 16        | AL   | 6    | 27AT5048N | 75,15 | -    | 50 | 21 | 27 | 8 | 0,280   |
|    | 25        | AL   | 6    | 36AT5048N | 75,15 | -    | 50 | 30 | 36 | 8 | 0,400   |
| 60 | 10        | AL   | 6    | 21AT5060N | 94,25 | -    | 65 | 15 | 21 | 8 | 0,307   |
|    | 16        | AL   | 6    | 27AT5060N | 94,25 | -    | 65 | 21 | 27 | 8 | 0,430   |
|    | 25        | AL   | 6    | 36AT5060N | 94,25 | -    | 65 | 30 | 36 | 8 | 0,614   |

# T 10

10 mm

## VORGEBOHRT

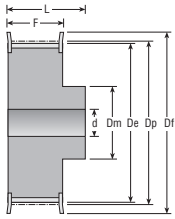

Figur 6F

| Z  | Riemenbr. | Mat. | Fig. | Best. Nr. | De    | Df | Dm | F  | L  | d  | Gewicht |
|----|-----------|------|------|-----------|-------|----|----|----|----|----|---------|
| 12 | 16        | AL   | 6F   | 31T10012N | 36,35 | 42 | 28 | 21 | 31 | 6  | 0,076   |
|    | 25        | AL   | 6F   | 40T10012N | 36,35 | 42 | 28 | 30 | 40 | 6  | 0,099   |
| 14 | 16        | AL   | 6F   | 31T10014N | 42,70 | 48 | 32 | 21 | 31 | 8  | 0,104   |
|    | 25        | AL   | 6F   | 40T10014N | 42,70 | 48 | 32 | 30 | 40 | 8  | 0,134   |
| 15 | 16        | AL   | 6F   | 31T10015N | 45,90 | 51 | 32 | 21 | 31 | 8  | 0,116   |
|    | 25        | AL   | 6F   | 40T10015N | 45,90 | 51 | 32 | 30 | 40 | 8  | 0,152   |
| 16 | 16        | AL   | 6F   | 31T10016N | 49,05 | 54 | 35 | 21 | 31 | 8  | 0,134   |
|    | 25        | AL   | 6F   | 40T10016N | 49,05 | 54 | 35 | 30 | 40 | 8  | 0,176   |
| 18 | 16        | AL   | 6F   | 31T10018N | 55,45 | 60 | 40 | 21 | 31 | 8  | 0,167   |
|    | 25        | AL   | 6F   | 40T10018N | 55,45 | 60 | 40 | 30 | 40 | 8  | 0,224   |
|    | 32        | AL   | 6F   | 47T10018N | 55,45 | 60 | 40 | 37 | 47 | 10 | 0,253   |
|    | 50        | AL   | 6F   | 66T10018N | 55,45 | 60 | 40 | 56 | 66 | 10 | 0,422   |
| 19 | 16        | AL   | 6F   | 31T10019N | 58,60 | 66 | 44 | 21 | 31 | 8  | 0,184   |
|    | 25        | AL   | 6F   | 40T10019N | 58,60 | 66 | 44 | 30 | 40 | 8  | 0,247   |
|    | 32        | AL   | 6F   | 47T10019N | 58,60 | 66 | 44 | 37 | 47 | 10 | 0,286   |
|    | 50        | AL   | 6F   | 66T10019N | 58,60 | 66 | 44 | 56 | 66 | 10 | 0,466   |
| 20 | 16        | AL   | 6F   | 31T10020N | 61,80 | 66 | 46 | 21 | 31 | 8  | 0,208   |
|    | 25        | AL   | 6F   | 40T10020N | 61,80 | 66 | 46 | 30 | 40 | 8  | 0,276   |
|    | 32        | AL   | 6F   | 47T10020N | 61,80 | 66 | 46 | 37 | 47 | 12 | 0,322   |
|    | 50        | AL   | 6F   | 66T10020N | 61,80 | 66 | 46 | 56 | 66 | 12 | 0,520   |
| 22 | 16        | AL   | 6F   | 31T10022N | 68,15 | 75 | 52 | 21 | 31 | 8  | 0,253   |
|    | 25        | AL   | 6F   | 40T10022N | 68,15 | 75 | 52 | 30 | 40 | 8  | 0,337   |
|    | 32        | AL   | 6F   | 47T10022N | 68,15 | 75 | 52 | 37 | 47 | 12 | 0,393   |
|    | 50        | AL   | 6F   | 66T10022N | 68,15 | 75 | 52 | 56 | 66 | 12 | 0,570   |
| 24 | 16        | AL   | 6F   | 31T10024N | 74,55 | 83 | 58 | 21 | 31 | 8  | 0,288   |
|    | 25        | AL   | 6F   | 40T10024N | 74,55 | 83 | 58 | 30 | 40 | 8  | 0,392   |
|    | 32        | AL   | 6F   | 47T10024N | 74,55 | 83 | 58 | 37 | 47 | 12 | 0,475   |
|    | 50        | AL   | 6F   | 66T10024N | 74,55 | 83 | 58 | 56 | 66 | 12 | 0,736   |
| 25 | 16        | AL   | 6F   | 31T10025N | 77,70 | 83 | 60 | 21 | 31 | 8  | 0,310   |
|    | 25        | AL   | 6F   | 40T10025N | 77,70 | 83 | 60 | 30 | 40 | 8  | 0,422   |
|    | 32        | AL   | 6F   | 47T10025N | 77,70 | 83 | 60 | 37 | 47 | 12 | 0,527   |
|    | 50        | AL   | 6F   | 66T10025N | 77,70 | 83 | 60 | 56 | 66 | 12 | 0,766   |
| 26 | 16        | AL   | 6F   | 31T10026N | 80,90 | 87 | 60 | 21 | 31 | 8  | 0,357   |
|    | 25        | AL   | 6F   | 40T10026N | 80,90 | 87 | 60 | 30 | 40 | 8  | 0,477   |
|    | 32        | AL   | 6F   | 47T10026N | 80,90 | 87 | 60 | 37 | 47 | 12 | 0,564   |
|    | 50        | AL   | 6F   | 66T10026N | 80,90 | 87 | 60 | 56 | 66 | 12 | 0,816   |
| 27 | 16        | AL   | 6F   | 31T10027N | 84,10 | 91 | 60 | 21 | 31 | 8  | 0,364   |
|    | 25        | AL   | 6F   | 40T10027N | 84,10 | 91 | 60 | 30 | 40 | 8  | 0,536   |
|    | 32        | AL   | 6F   | 47T10027N | 84,10 | 91 | 60 | 37 | 47 | 12 | 0,602   |
|    | 50        | AL   | 6F   | 66T10027N | 84,10 | 91 | 60 | 56 | 66 | 12 | 0,946   |
| 28 | 16        | AL   | 6F   | 31T10028N | 87,25 | 93 | 60 | 21 | 31 | 8  | 0,401   |
|    | 25        | AL   | 6F   | 40T10028N | 87,25 | 93 | 60 | 30 | 40 | 8  | 0,540   |
|    | 32        | AL   | 6F   | 47T10028N | 87,25 | 93 | 60 | 37 | 47 | 12 | 0,642   |
|    | 50        | AL   | 6F   | 66T10028N | 87,25 | 93 | 60 | 56 | 66 | 12 | 0,960   |

# T 10

10 mm

VORGEBOHRT

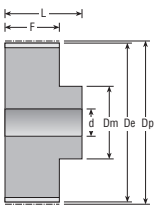

Figur 6

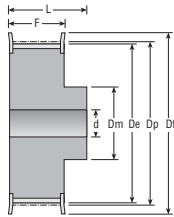

Figur 6F

| Z  | Riemenbr. | Mat. | Fig. | Best. Nr. | De     | Df  | Dm  | F  | L  | d  | Gewicht |
|----|-----------|------|------|-----------|--------|-----|-----|----|----|----|---------|
| 30 | 16        | AL   | 6F   | 31T10030N | 93,65  | 97  | 60  | 21 | 31 | 8  | 0,441   |
|    | 25        | AL   | 6F   | 40T10030N | 93,65  | 97  | 60  | 30 | 40 | 8  | 0,640   |
|    | 32        | AL   | 6F   | 47T10030N | 93,65  | 97  | 60  | 37 | 47 | 12 | 0,740   |
|    | 50        | AL   | 6F   | 66T10030N | 93,65  | 97  | 60  | 56 | 66 | 12 | 1,169   |
| 32 | 16        | AL   | 6F   | 31T10032N | 100,00 | 106 | 65  | 21 | 31 | 10 | 0,493   |
|    | 25        | AL   | 6F   | 40T10032N | 100,00 | 106 | 65  | 30 | 40 | 10 | 0,693   |
|    | 32        | AL   | 6F   | 47T10032N | 100,00 | 106 | 65  | 37 | 47 | 12 | 0,844   |
|    | 50        | AL   | 6F   | 66T10032N | 100,00 | 106 | 65  | 56 | 66 | 12 | 1,300   |
| 36 | 16        | AL   | 6F   | 31T10036N | 112,75 | 119 | 70  | 21 | 31 | 10 | 0,623   |
|    | 25        | AL   | 6F   | 40T10036N | 112,75 | 119 | 70  | 30 | 40 | 10 | 0,873   |
|    | 32        | AL   | 6F   | 47T10036N | 112,75 | 119 | 70  | 37 | 47 | 16 | 1,083   |
|    | 50        | AL   | 6F   | 66T10036N | 112,75 | 119 | 70  | 56 | 66 | 16 | 1,637   |
| 40 | 16        | AL   | 6F   | 31T10040N | 125,45 | 131 | 80  | 21 | 31 | 10 | 0,767   |
|    | 25        | AL   | 6F   | 40T10040N | 125,45 | 131 | 80  | 30 | 40 | 10 | 1,067   |
|    | 32        | AL   | 6F   | 47T10040N | 125,45 | 131 | 80  | 37 | 47 | 16 | 1,317   |
|    | 50        | AL   | 6F   | 66T10040N | 125,45 | 131 | 80  | 56 | 66 | 16 | 1,999   |
| 44 | 16        | AL   | 6    | 31T10044N | 138,20 | -   | 88  | 21 | 31 | 10 | 0,993   |
|    | 25        | AL   | 6    | 40T10044N | 138,20 | -   | 88  | 30 | 40 | 10 | 1,350   |
|    | 32        | AL   | 6    | 47T10044N | 138,20 | -   | 88  | 37 | 47 | 16 | 1,611   |
|    | 50        | AL   | 6    | 66T10044N | 138,20 | -   | 88  | 56 | 66 | 16 | 2,357   |
| 48 | 16        | AL   | 6    | 31T10048N | 150,95 | -   | 95  | 21 | 31 | 16 | 1,090   |
|    | 25        | AL   | 6    | 40T10048N | 150,95 | -   | 95  | 30 | 40 | 16 | 1,516   |
|    | 32        | AL   | 6    | 47T10048N | 150,95 | -   | 95  | 37 | 47 | 16 | 1,931   |
|    | 50        | AL   | 6    | 66T10048N | 150,95 | -   | 95  | 56 | 66 | 16 | 2,830   |
| 60 | 16        | AL   | 6    | 31T10060N | 189,10 | -   | 110 | 21 | 31 | 16 | 1,710   |
|    | 25        | AL   | 6    | 40T10060N | 189,10 | -   | 110 | 30 | 40 | 16 | 2,339   |
|    | 32        | AL   | 6    | 47T10060N | 189,10 | -   | 110 | 37 | 47 | 16 | 3,004   |
|    | 50        | AL   | 6    | 66T10060N | 189,10 | -   | 110 | 56 | 66 | 16 | 4,366   |

# AT 10

10 mm

## VORGEBOHRT

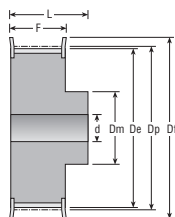

Figur 6F

| Z  | Riemenbr. | Mat. | Fig. | Best. Nr.  | De    | Df | Dm | F  | L  | d  | Gewicht |
|----|-----------|------|------|------------|-------|----|----|----|----|----|---------|
| 12 | 16        | AL   | 6F   | 31AT10012N | 36,35 | 42 | 28 | 21 | 31 | 6  | 0,076   |
|    | 25        | AL   | 6F   | 40AT10012N | 36,35 | 42 | 28 | 30 | 40 | 6  | 0,099   |
| 14 | 16        | AL   | 6F   | 31AT10014N | 42,70 | 48 | 32 | 21 | 31 | 8  | 0,104   |
|    | 25        | AL   | 6F   | 40AT10014N | 42,70 | 48 | 32 | 30 | 40 | 8  | 0,134   |
| 15 | 16        | AL   | 6F   | 31AT10015N | 45,90 | 51 | 32 | 21 | 31 | 8  | 0,116   |
|    | 25        | AL   | 6F   | 40AT10015N | 45,90 | 51 | 32 | 30 | 40 | 8  | 0,152   |
| 16 | 16        | AL   | 6F   | 31AT10016N | 49,05 | 54 | 35 | 21 | 31 | 8  | 0,134   |
|    | 25        | AL   | 6F   | 40AT10016N | 49,05 | 54 | 35 | 30 | 40 | 8  | 0,176   |
| 18 | 16        | AL   | 6F   | 31AT10018N | 55,45 | 60 | 40 | 21 | 31 | 8  | 0,167   |
|    | 25        | AL   | 6F   | 40AT10018N | 55,45 | 60 | 40 | 30 | 40 | 8  | 0,224   |
|    | 32        | AL   | 6F   | 47AT10018N | 55,45 | 60 | 40 | 37 | 47 | 10 | 0,253   |
|    | 50        | AL   | 6F   | 66AT10018N | 55,45 | 60 | 40 | 56 | 66 | 10 | 0,422   |
| 19 | 16        | AL   | 6F   | 31AT10019N | 58,60 | 66 | 44 | 21 | 31 | 8  | 0,184   |
|    | 25        | AL   | 6F   | 40AT10019N | 58,60 | 66 | 44 | 30 | 40 | 8  | 0,247   |
|    | 32        | AL   | 6F   | 47AT10019N | 58,60 | 66 | 44 | 37 | 47 | 10 | 0,286   |
|    | 50        | AL   | 6F   | 66AT10019N | 58,60 | 66 | 44 | 56 | 66 | 10 | 0,466   |
| 20 | 16        | AL   | 6F   | 31AT10020N | 61,80 | 66 | 46 | 21 | 31 | 8  | 0,208   |
|    | 25        | AL   | 6F   | 40AT10020N | 61,80 | 66 | 46 | 30 | 40 | 8  | 0,276   |
|    | 32        | AL   | 6F   | 47AT10020N | 61,80 | 66 | 46 | 37 | 47 | 12 | 0,322   |
|    | 50        | AL   | 6F   | 66AT10020N | 61,80 | 66 | 46 | 56 | 66 | 12 | 0,520   |
| 22 | 16        | AL   | 6F   | 31AT10022N | 68,15 | 75 | 52 | 21 | 31 | 8  | 0,253   |
|    | 25        | AL   | 6F   | 40AT10022N | 68,15 | 75 | 52 | 30 | 40 | 8  | 0,337   |
|    | 32        | AL   | 6F   | 47AT10022N | 68,15 | 75 | 52 | 37 | 47 | 12 | 0,393   |
|    | 50        | AL   | 6F   | 66AT10022N | 68,15 | 75 | 52 | 56 | 66 | 12 | 0,570   |
| 24 | 16        | AL   | 6F   | 31AT10024N | 74,55 | 83 | 58 | 21 | 31 | 8  | 0,288   |
|    | 25        | AL   | 6F   | 40AT10024N | 74,55 | 83 | 58 | 30 | 40 | 8  | 0,392   |
|    | 32        | AL   | 6F   | 47AT10024N | 74,55 | 83 | 58 | 37 | 47 | 12 | 0,475   |
|    | 50        | AL   | 6F   | 66AT10024N | 74,55 | 83 | 58 | 56 | 66 | 12 | 0,736   |
| 25 | 16        | AL   | 6F   | 31AT10025N | 77,70 | 83 | 60 | 21 | 31 | 8  | 0,310   |
|    | 25        | AL   | 6F   | 40AT10025N | 77,70 | 83 | 60 | 30 | 40 | 8  | 0,422   |
|    | 32        | AL   | 6F   | 47AT10025N | 77,70 | 83 | 60 | 37 | 47 | 12 | 0,527   |
|    | 50        | AL   | 6F   | 66AT10025N | 77,70 | 83 | 60 | 56 | 66 | 12 | 0,766   |
| 26 | 16        | AL   | 6F   | 31AT10026N | 80,90 | 87 | 60 | 21 | 31 | 8  | 0,357   |
|    | 25        | AL   | 6F   | 40AT10026N | 80,90 | 87 | 60 | 30 | 40 | 8  | 0,477   |
|    | 32        | AL   | 6F   | 47AT10026N | 80,90 | 87 | 60 | 37 | 47 | 12 | 0,564   |
|    | 50        | AL   | 6F   | 66AT10026N | 80,90 | 87 | 60 | 56 | 66 | 12 | 0,816   |
| 27 | 16        | AL   | 6F   | 31AT10027N | 84,10 | 91 | 60 | 21 | 31 | 8  | 0,364   |
|    | 25        | AL   | 6F   | 40AT10027N | 84,10 | 91 | 60 | 30 | 40 | 8  | 0,536   |
|    | 32        | AL   | 6F   | 47AT10027N | 84,10 | 91 | 60 | 37 | 47 | 12 | 0,602   |
|    | 50        | AL   | 6F   | 66AT10027N | 84,10 | 91 | 60 | 56 | 66 | 12 | 0,946   |
| 28 | 16        | AL   | 6F   | 31AT10028N | 87,25 | 93 | 60 | 21 | 31 | 8  | 0,401   |
|    | 25        | AL   | 6F   | 40AT10028N | 87,25 | 93 | 60 | 30 | 40 | 8  | 0,540   |
|    | 32        | AL   | 6F   | 47AT10028N | 87,25 | 93 | 60 | 37 | 47 | 12 | 0,642   |
|    | 50        | AL   | 6F   | 66AT10028N | 87,25 | 93 | 60 | 56 | 66 | 12 | 0,960   |



# AT 10

10 mm

VORGEBOHRT

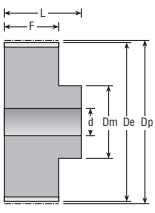

Figur 6

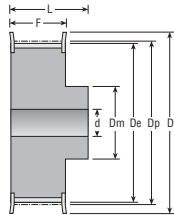

Figur 6F

| Z  | Riemenbr. | Mat. | Fig. | Best. Nr.  | De     | Df  | Dm  | F  | L  | d  | Gewicht |
|----|-----------|------|------|------------|--------|-----|-----|----|----|----|---------|
| 30 | 16        | AL   | 6F   | 31AT10030N | 93,65  | 97  | 60  | 21 | 31 | 8  | 0,441   |
|    | 25        | AL   | 6F   | 40AT10030N | 93,65  | 97  | 60  | 30 | 40 | 8  | 0,640   |
|    | 32        | AL   | 6F   | 47AT10030N | 93,65  | 97  | 60  | 37 | 47 | 12 | 0,740   |
|    | 50        | AL   | 6F   | 66AT10030N | 93,65  | 97  | 60  | 56 | 66 | 12 | 1,169   |
| 32 | 16        | AL   | 6F   | 31AT10032N | 100,00 | 106 | 65  | 21 | 31 | 10 | 0,493   |
|    | 25        | AL   | 6F   | 40AT10032N | 100,00 | 106 | 65  | 30 | 40 | 10 | 0,693   |
|    | 32        | AL   | 6F   | 47AT10032N | 100,00 | 106 | 65  | 37 | 47 | 12 | 0,844   |
|    | 50        | AL   | 6F   | 66AT10032N | 100,00 | 106 | 65  | 56 | 66 | 12 | 1,300   |
| 36 | 16        | AL   | 6F   | 31AT10036N | 112,75 | 119 | 70  | 21 | 31 | 10 | 0,623   |
|    | 25        | AL   | 6F   | 40AT10036N | 112,75 | 119 | 70  | 30 | 40 | 10 | 0,873   |
|    | 32        | AL   | 6F   | 47AT10036N | 112,75 | 119 | 70  | 37 | 47 | 16 | 1,083   |
|    | 50        | AL   | 6F   | 66AT10036N | 112,75 | 119 | 70  | 56 | 66 | 16 | 1,637   |
| 40 | 16        | AL   | 6F   | 31AT10040N | 125,45 | 131 | 80  | 21 | 31 | 10 | 0,767   |
|    | 25        | AL   | 6F   | 40AT10040N | 125,45 | 131 | 80  | 30 | 40 | 10 | 1,067   |
|    | 32        | AL   | 6F   | 47AT10040N | 125,45 | 131 | 80  | 37 | 47 | 16 | 1,317   |
|    | 50        | AL   | 6F   | 66AT10040N | 125,45 | 131 | 80  | 56 | 66 | 16 | 1,999   |
| 44 | 16        | AL   | 6    | 31AT10044N | 138,20 | -   | 88  | 21 | 31 | 10 | 0,993   |
|    | 25        | AL   | 6    | 40AT10044N | 138,20 | -   | 88  | 30 | 40 | 10 | 1,350   |
|    | 32        | AL   | 6    | 47AT10044N | 138,20 | -   | 88  | 37 | 47 | 16 | 1,611   |
|    | 50        | AL   | 6    | 66AT10044N | 138,20 | -   | 88  | 56 | 66 | 16 | 2,357   |
| 48 | 16        | AL   | 6    | 31AT10048N | 150,95 | -   | 95  | 21 | 31 | 16 | 1,090   |
|    | 25        | AL   | 6    | 40AT10048N | 150,95 | -   | 95  | 30 | 40 | 16 | 1,516   |
|    | 32        | AL   | 6    | 47AT10048N | 150,95 | -   | 95  | 37 | 47 | 16 | 1,931   |
|    | 50        | AL   | 6    | 66AT10048N | 150,95 | -   | 95  | 56 | 66 | 16 | 2,830   |
| 60 | 16        | AL   | 6    | 31AT10060N | 189,10 | -   | 110 | 21 | 31 | 16 | 1,710   |
|    | 25        | AL   | 6    | 40AT10060N | 189,10 | -   | 110 | 30 | 40 | 16 | 2,339   |
|    | 32        | AL   | 6    | 47AT10060N | 189,10 | -   | 110 | 37 | 47 | 16 | 3,004   |
|    | 50        | AL   | 6    | 66AT10060N | 189,10 | -   | 110 | 56 | 66 | 16 | 4,366   |