

XL

1/5" (5,08 mm)

VORGEBOHRT

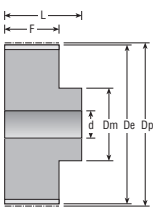

Figur 6

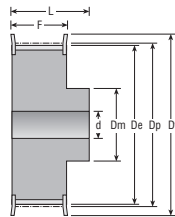

Figur 6F

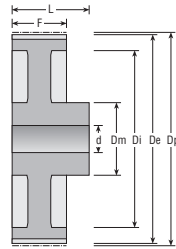

Figur 6W

Z	Riemenbr.	Mat.	Fig.	Best. Nr.	Dp	De	Df	Dm	F	L	d	Max. Bohr.	Gewicht
10	37	ST	6F	010XL037N	16,17	15,66	23	9,5	14,3	19,8	5	6,4	0,02
	37	AL	6F	010XL037A	16,17	15,66	23	9,5	14,3	19,8	5	6,4	0,02
11	37	ST	6F	011XL037N	17,79	17,28	23	9,5	14,3	19,8	5	6,4	0,02
	37	AL	6F	011XL037A	17,79	17,28	23	9,5	14,3	19,8	5	6,4	0,02
12	37	ST	6F	012XL037N	19,40	18,90	25	12,7	14,3	19,8	5	7,9	0,03
	37	AL	6F	012XL037A	19,40	18,90	25	12,7	14,3	19,8	5	7,9	0,03
14	37	ST	6F	014XL037N	22,64	22,13	28	14,3	14,3	19,8	6	9,5	0,04
	37	AL	6F	014XL037A	22,64	22,13	28	14,3	14,3	19,8	6	9,5	0,04
15	37	ST	6F	015XL037N	24,26	23,75	28	15,9	14,3	19,8	6	11,1	0,04
	37	AL	6F	015XL037A	24,26	23,75	28	15,9	14,3	19,8	6	11,1	0,04
16	37	ST	6F	016XL037N	25,87	25,36	32	17,5	14,3	19,8	6	12,7	0,05
	37	AL	6F	016XL037A	25,87	25,36	32	17,5	14,3	19,8	6	12,7	0,05
18	37	ST	6F	018XL037N	29,11	28,60	36	19,0	14,3	19,8	6	14,3	0,06
	37	AL	6F	018XL037A	29,11	28,60	36	19,0	14,3	19,8	6	14,3	0,06
19	37	ST	6F	019XL037N	30,72	30,21	36	20,0	14,3	19,8	6	14,5	0,08
20	37	ST	6F	020XL037N	32,34	31,83	38	23,8	14,3	22,2	6	17,5	0,08
	37	AL	6F	020XL037A	32,34	31,83	38	23,8	14,3	22,2	6	17,5	0,08
21	37	ST	6F	021XL037N	33,96	33,45	38	23,8	14,3	22,2	6	17,5	0,09
	37	AL	6F	021XL037A	33,96	33,45	38	23,8	14,3	22,2	6	17,5	0,09
22	37	ST	6F	022XL037N	35,57	35,07	42	25,4	14,3	22,2	6	19,1	0,10
	37	AL	6F	022XL037A	35,57	35,07	42	25,4	14,3	22,2	6	19,1	0,10
24	37	ST	6F	024XL037N	38,81	38,30	44	27,0	14,3	22,2	6	20,6	0,12
	37	AL	6F	024XL037A	38,81	38,30	44	27,0	14,3	22,2	6	20,6	0,12
26	37	ST	6F	026XL037N	42,04	41,53	48	30,0	14,3	22,2	6	23,0	0,14
	37	AL	6F	026XL037A	42,04	41,53	48	30,0	14,3	22,2	6	23,0	0,14
28	37	ST	6F	028XL037N	45,28	44,77	51	30,2	14,3	22,2	6	23,0	0,16
	37	AL	6F	028XL037A	45,28	44,77	51	30,2	14,3	22,2	6	23,0	0,16
30	37	ST	6F	030XL037N	48,51	48,00	54	34,9	14,3	22,2	6	23,0	0,19
	37	AL	6F	030XL037A	48,51	48,00	54	34,9	14,3	22,2	6	23,0	0,19
32	37	AL	6	032XL037N	51,74	51,24	-	38,0	14,3	25,4	8	23,0	0,11
36	37	AL	6	036XL037N	58,21	57,70	-	38,0	14,3	25,4	8	23,0	0,13
40	37	AL	6	040XL037N	64,68	64,17	-	38,0	14,3	25,4	8	23,0	0,17
42	37	AL	6W	042XL037N	67,91	67,41	-	38,0	14,3	25,4	8	23,0	0,13
44	37	AL	6W	044XL037N	71,15	70,64	-	38,0	14,3	25,4	8	23,0	0,15
48	37	AL	6W	048XL037N	77,62	77,11	-	38,0	14,3	25,4	8	23,0	0,16
60	37	AL	6W	060XL037N	97,02	96,51	-	38,0	14,3	25,4	8	23,0	0,18
72	37	AL	6W	072XL037N	116,43	115,92	-	38,0	14,3	25,4	8	23,0	0,23

L

VORGEBOHRT

3/8" (9,525 mm)

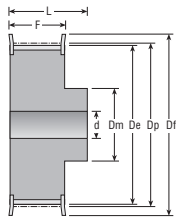

Figur 6F

Z	Riemenbr.	Mat.	Fig.	Best. Nr.	Dp	De	Df	Dm	F	L	E	d	Max. Bohr.	Gewicht
10	50	ST	6F	010L050N	30,32	29,59	36	22	19	26	-	6	13	0,11
	75	ST	6F	010L075N	30,32	29,59	36	22	25	32	-	6	13	0,15
	100	ST	6F	010L100N	30,32	29,59	36	22	31	38	-	6	13	0,18
12	50	ST	6F	012L050N	36,38	35,62	42	28	19	26	-	6	17	0,19
	75	ST	6F	012L075N	36,38	35,62	42	28	25	32	-	8	17	0,23
	100	ST	6F	012L100N	36,38	35,62	42	28	31	38	-	8	17	0,29
13	50	ST	6F	013L050N	39,41	38,65	44	30	19	26	-	6	19	0,21
	75	ST	6F	013L075N	39,41	38,65	44	30	25	32	-	8	19	0,26
	100	ST	6F	013L100N	39,41	38,65	44	30	31	38	-	8	19	0,30
14	50	ST	6F	014L050N	42,45	41,68	48	33	19	26	-	8	20	0,25
	75	ST	6F	014L075N	42,45	41,68	48	33	25	32	-	8	20	0,32
	100	ST	6F	014L100N	42,45	41,68	48	33	31	38	-	8	20	0,38
15	50	ST	6F	015L050N	45,48	44,72	51	36	19	26	-	8	23	0,30
	75	ST	6F	015L075N	45,48	44,72	51	36	25	32	-	8	23	0,35
	100	ST	6F	015L100N	45,48	44,72	51	36	31	38	-	8	23	0,40
16	50	ST	6F	016L050N	48,51	47,75	54	38	19	26	-	8	23	0,33
	75	ST	6F	016L075N	48,51	47,75	54	38	25	32	-	8	23	0,42
	100	ST	6F	016L100N	48,51	47,75	54	38	31	38	-	8	23	0,51
17	50	ST	6F	017L050N	51,54	50,78	57	40	19	26	-	10	24	0,36
	75	ST	6F	017L075N	51,54	50,78	57	40	25	32	-	10	24	0,45
	100	ST	6F	017L100N	51,54	50,78	57	40	31	38	-	10	24	0,54
18	50	ST	6F	018L050N	54,57	53,81	60	40	19	26	-	10	24	0,41
	75	ST	6F	018L075N	54,57	53,81	60	40	25	32	-	10	24	0,51
	100	ST	6F	018L100N	54,57	53,81	60	40	31	38	-	10	24	0,62
19	50	ST	6F	019L050N	57,61	56,84	60	40	19	26	-	10	24	0,45
	75	ST	6F	019L075N	57,61	56,84	60	40	25	32	-	10	24	0,57
	100	ST	6F	019L100N	57,61	56,84	60	40	31	38	-	10	24	0,69
20	50	ST	6F	020L050N	60,64	59,88	66	46	19	26	-	10	28	0,50
	75	ST	6F	020L075N	60,64	59,88	66	46	25	32	-	10	28	0,63
	100	ST	6F	020L100N	60,64	59,88	66	46	31	38	-	10	28	0,76
21	50	ST	6F	021L050N	63,67	62,91	71	46	19	26	-	10	28	0,55
	75	ST	6F	021L075N	63,67	62,91	71	46	25	32	-	10	28	0,70
	100	ST	6F	021L100N	63,67	62,91	71	46	31	38	-	10	28	0,82
22	50	ST	6F	022L050N	66,70	65,94	75	50	19	26	-	10	30	0,62
	75	ST	6F	022L075N	66,70	65,94	75	50	25	32	-	10	30	0,75
	100	ST	6F	022L100N	66,70	65,94	75	50	31	38	-	10	30	0,92
24	50	ST	6F	024L050N	72,77	72,00	79	50	19	26	-	12	30	0,68
	75	ST	6F	024L075N	72,77	72,00	79	50	25	32	-	12	30	0,85
	100	ST	6F	024L100N	72,77	72,00	79	50	31	38	-	12	30	1,10
26	50	ST	6F	026L050N	78,83	78,07	87	50	19	26	-	12	30	0,82
	75	ST	6F	026L075N	78,83	78,07	87	50	25	32	-	12	30	1,00
	100	ST	6F	026L100N	78,83	78,07	87	50	31	38	-	12	30	1,30
28	50	ST	6F	028L050N	84,89	84,13	91	50	19	26	-	12	30	0,92
	75	ST	6F	028L075N	84,89	84,13	91	50	25	32	-	12	30	1,20
	100	ST	6F	028L100N	84,89	84,13	91	50	31	38	-	12	30	1,40

L

3/8" (9,525 mm)

VORGEBOHRT

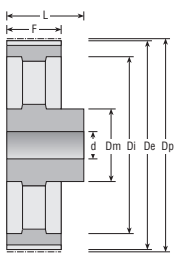

Figur 6A

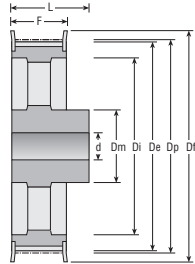

Figur 6AF

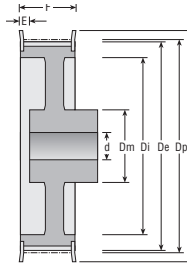

Figur 6CWF

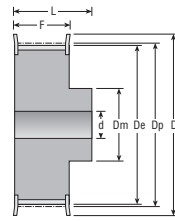

Figur 6F

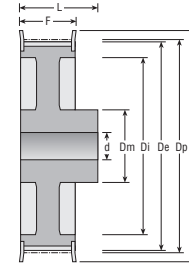

Figur 6WF

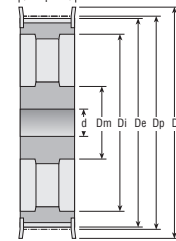

Figur 10AF

Z	Riemenbr.	Mat.	Fig.	Best. Nr.	Dp	De	Df	Dm	F	L	E	d	Max. Bohr.	Gewicht
30	50	ST	6F	030L050N	90,96	90,20	97	50	19	26	-	12	30	1,10
	75	ST	6F	030L075N	90,96	90,20	97	50	25	32	-	12	30	1,40
	100	ST	6F	030L100N	90,96	90,20	97	50	31	38	-	12	30	1,70
32	50	ST	6F	032L050N	97,02	96,26	103	50	19	26	-	12	30	1,20
	75	ST	6F	032L075N	97,02	96,26	103	50	25	32	-	12	30	1,50
	100	ST	6F	032L100N	97,02	96,26	103	50	31	38	-	12	30	1,80
36	50	GG	6WF	036L050N	109,15	108,39	115	50	19	26	-	12	30	1,00
	75	GG	6WF	036L075N	109,15	108,39	115	55	25	32	-	12	32	1,30
	100	GG	6CWF	036L100N	109,15	108,39	115	55	32	32	6	12	32	1,50
40	50	GG	6WF	040L050N	121,28	120,51	127	50	19	26	-	12	30	1,10
	75	GG	6WF	040L075N	121,28	120,51	127	60	25	32	-	12	35	1,60
	100	GG	6CWF	040L100N	121,28	120,51	127	60	32	32	6	12	35	1,80
44	50	GG	6AF	044L050N	133,40	132,64	140	50	19	26	-	12	30	1,20
	75	GG	6AF	044L075N	133,40	132,64	140	60	25	32	-	12	35	1,70
	100	GG	10AF	044L100N	133,40	132,64	140	60	32	-	-	12	35	1,90
48	50	GG	6AF	048L050N	145,53	144,77	152	50	19	26	-	12	30	1,30
	75	GG	6AF	048L075N	145,53	144,77	152	60	25	32	-	12	35	1,90
	100	GG	10AF	048L100N	145,53	144,77	152	60	32	-	-	12	35	2,10
60	50	GG	6A	060L050N	181,91	181,15	-	50	19	28	-	15	30	1,30
	75	GG	6A	060L075N	181,91	181,15	-	60	26	35	-	15	35	1,80
	100	GG	6A	060L100N	181,91	181,15	-	60	32	35	-	15	35	2,00
72	50	GG	6A	072L050N	218,30	217,53	-	50	19	28	-	15	30	1,70
	75	GG	6A	072L075N	218,30	217,53	-	60	26	35	-	15	35	2,30
	100	GG	6A	072L100N	218,30	217,53	-	60	32	35	-	15	35	2,50
84	50	GG	6A	084L050N	254,68	253,92	-	50	19	28	-	15	30	1,90
	75	GG	6A	084L075N	254,68	253,92	-	60	29	35	-	15	35	2,50
	100	GG	6A	084L100N	254,68	253,92	-	60	32	35	-	15	35	2,70

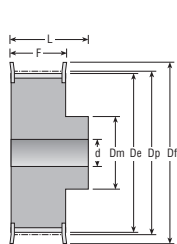

Figur 6F

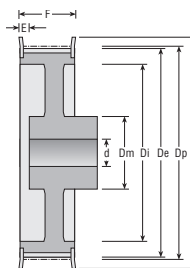

Figur 6CWF

Z	Riemenbr.	Mat.	Fig.	Best. Nr.	Dp	De	Df	Dm	F	L	E	d	Max. Bohr.	Gewicht
14	075	ST	6F	014H075N	56,60	55,22	64	40	26,4	40	-	10	24	0,50
	100	ST	6F	014H100N	56,60	55,22	63	40	31	41	-	10	24	0,65
	150	ST	6F	014H150N	56,60	55,22	63	40	44	54	-	12	24	0,82
	200	ST	6F	014H200N	56,60	55,22	63	40	58	68	-	12	24	1,10
16	075	ST	6F	016H075N	64,68	63,31	70	46	26,4	40	-	10	28	0,60
	100	ST	6F	016H100N	64,68	63,31	71	46	31	41	-	10	28	0,85
	150	ST	6F	016H150N	64,68	63,31	71	46	44	54	-	12	28	1,10
	200	ST	6F	016H200N	64,68	63,31	71	46	58	68	-	15	28	1,40
	300	ST	6F	016H300N	64,68	63,31	71	46	84	94	-	15	28	2,00
18	075	ST	6F	018H075N	72,77	71,39	79	54	26,4	40	-	12	32	0,80
	100	ST	6F	018H100N	72,77	71,39	79	54	31	41	-	12	32	1,10
	150	ST	6F	018H150N	72,77	71,39	79	54	44	54	-	12	32	1,50
	200	ST	6F	018H200N	72,77	71,39	79	54	58	68	-	15	32	1,80
	300	ST	6F	018H300N	72,77	71,39	79	54	84	94	-	15	32	2,60
19	075	ST	6F	019H075N	76,81	75,44	82,5	58	26,4	40	-	12	34	1,00
	100	ST	6F	019H100N	76,81	75,44	82	58	31	41	-	12	34	1,20
	150	ST	6F	019H150N	76,81	75,44	82	58	44	54	-	12	34	1,70
	200	ST	6F	019H200N	76,81	75,44	82	58	58	68	-	15	34	2,10
	300	ST	6F	019H300N	76,81	75,44	82	58	84	94	-	15	34	2,90
20	075	ST	6F	020H075N	80,85	79,48	87	62	26,4	40	-	12	35	1,10
	100	ST	6F	020H100N	80,85	79,48	87	62	31	41	-	12	35	1,40
	150	ST	6F	020H150N	80,85	79,48	87	62	44	54	-	12	35	1,80
	200	ST	6F	020H200N	80,85	79,48	87	62	58	68	-	15	35	2,30
	300	ST	6F	020H300N	80,85	79,48	87	62	84	94	-	15	35	3,20
21	075	ST	6F	021H075N	84,89	83,52	91	67	26,4	40	-	12	38	1,20
	100	ST	6F	021H100N	84,89	83,52	91	67	31	41	-	12	38	1,60
	150	ST	6F	021H150N	84,89	83,52	91	67	44	54	-	12	38	2,20
	200	ST	6F	021H200N	84,89	83,52	91	67	58	68	-	15	38	2,60
	300	ST	6F	021H300N	84,89	83,52	91	67	84	94	-	15	38	3,60
22	075	ST	6F	022H075N	88,94	87,56	94	70	26,4	40	-	12	41	1,40
	100	ST	6F	022H100N	88,94	87,56	93	70	31	41	-	12	41	1,70
	150	ST	6F	022H150N	88,94	87,56	93	70	44	54	-	12	41	2,30
	200	ST	6F	022H200N	88,94	87,56	93	70	58	68	-	15	41	2,80
	300	ST	6F	022H300N	88,94	87,56	93	70	84	94	-	15	41	4,00
24	075	ST	6F	024H075N	97,02	95,65	102	75	26,4	40	-	12	45	1,60
	100	ST	6F	024H100N	97,02	95,65	103	75	31	41	-	12	45	2,00
	150	ST	6F	024H150N	97,02	95,65	103	75	44	54	-	12	45	2,60
	200	ST	6F	024H200N	97,02	95,65	103	75	58	68	-	15	45	3,40
	300	ST	6F	024H300N	97,02	95,65	103	75	84	94	-	15	45	4,70
26	075	ST	6F	026H075N	105,11	103,73	112	80	26,4	40	-	15	45	1,80
	100	GG	6CWF	026H100N	105,11	103,73	111	55	32	32	8	15	32	1,40
	150	GG	6CWF	026H150N	105,11	103,73	111	55	45	35	18	15	32	1,70
	200	GG	6CWF	026H200N	105,11	103,73	111	60	58	42	24	15	35	2,30
	300	GG	6CWF	026H300N	105,11	103,73	111	60	84	57	35	15	35	3,30

H

1/2" (12,7 mm)

VORGEBOHRT

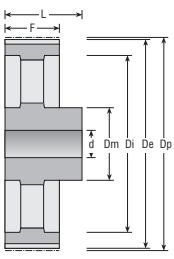

Figur 6A

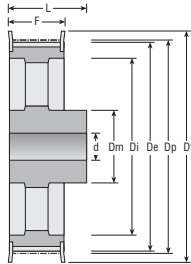

Figur 6AF

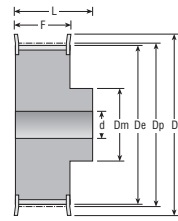

Figur 6F

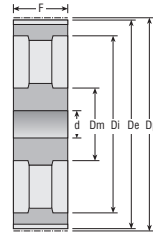

Figur 10A

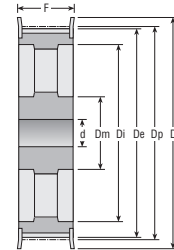

Figur 10AF

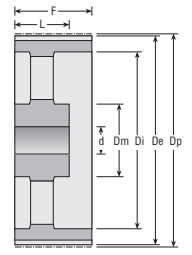

Figur 11A

Z	Riemenbr.	Mat.	Fig.	Best. Nr.	Dp	De	Df	Dm	F	L	E	d	Max. Bohr.	Gewicht
28	075	GG	6F	028H075N	113,19	111,82	120	80	26,4	40	-	15	45	2,00
	100	GG	6CWF	028H100N	113,19	111,82	119	60	32	32	8	15	35	1,60
	150	GG	6CWF	028H150N	113,19	111,82	119	60	45	35	18	15	35	1,90
	200	GG	6CWF	028H200N	113,19	111,82	119	60	58	42	24	15	35	2,50
	300	GG	6CWF	028H300N	113,19	111,82	119	60	84	57	35	15	35	3,60
30	075	GG	6F	030H075N	121,28	119,90	128	80	26,4	40	-	15	45	2,10
	100	GG	6CWF	030H100N	121,28	119,90	127	60	32	32	8	15	35	1,70
	150	GG	6CWF	030H150N	121,28	119,90	127	60	45	35	18	15	35	2,10
	200	GG	6CWF	030H200N	121,28	119,90	127	70	58	42	24	15	40	2,90
	300	GG	6CWF	030H300N	121,28	119,90	127	70	84	57	35	15	40	4,20
32	075	GG	6F	032H075N	129,36	127,99	135	70	27	40	15	15	40	2,20
	100	GG	6WF	032H100N	129,36	127,99	135	70	32	40	-	20	40	2,20
	150	GG	6CWF	032H150N	129,36	127,99	135	70	45	45	8	20	40	2,60
	200	GG	6CWF	032H200N	129,36	127,99	135	70	58	47	19	20	40	3,20
	300	GG	6CWF	032H300N	129,36	127,99	135	70	84	57	35	20	40	4,30
36	075	GG	6F	036H075N	145,53	144,16	152	80	26,4	40	-	20	45	2,40
	100	GG	6WF	036H100N	145,53	144,16	152	80	32	40	-	20	45	3,00
	150	GG	6CWF	036H150N	145,53	144,16	152	80	45	45	8	20	45	3,20
	200	GG	6CWF	036H200N	145,53	144,16	152	80	58	47	19	20	45	3,80
	300	GG	6CWF	036H300N	145,53	144,16	152	80	84	57	35	20	45	5,20
40	075	GG	6F	040H075N	161,70	160,33	168	80	26,4	40	-	20	45	2,80
	100	GG	6AF	040H100N	161,70	160,33	168	80	32	40	-	20	45	2,80
	150	GG	10AF	040H150N	161,70	160,33	168	80	45	-	-	20	45	3,80
	200	GG	11AF	040H200N	161,70	160,33	168	80	58	45	-	20	45	4,10
	300	GG	11AF	040H300N	161,70	160,33	168	80	84	55	-	20	45	5,60
44	075	GG	6AF	044H075N	177,87	176,50	184	80	26,4	40	-	20	45	2,70
	100	GG	6AF	044H100N	177,87	176,50	184	80	32	40	-	20	45	3,10
	150	GG	10AF	044H150N	177,87	176,50	184	80	45	-	-	20	45	3,70
	200	GG	11AF	044H200N	177,87	176,50	184	80	58	45	-	20	45	4,40
	300	GG	11AF	044H300N	177,87	176,50	184	80	84	55	-	20	45	5,90
48	075	GG	6AF	048H075N	194,04	192,67	200	90	26,4	40	-	20	45	3,00
	100	GG	6AF	048H100N	194,04	192,67	200	80	32	40	-	20	45	3,30
	150	GG	10AF	048H150N	194,04	192,67	200	80	45	-	-	20	45	4,00
	200	GG	11AF	048H200N	194,04	192,67	200	85	58	45	-	20	48	5,10
	300	GG	11AF	048H300N	194,04	192,67	200	85	84	55	-	20	48	6,60
60	100	GG	6A	060H100N	242,55	241,18	-	80	34	45	-	20	45	5,50
	150	GG	10A	060H150N	242,55	241,18	-	85	46	-	-	20	48	5,10
	200	GG	11A	060H200N	242,55	241,18	-	90	60	50	-	20	50	7,10
	300	GG	11A	060H300N	242,55	241,18	-	100	86	55	-	20	57	9,90
72	100	GG	6A	072H100N	291,06	289,69	-	80	34	45	-	20	45	7,10
	150	GG	10A	072H150N	291,06	289,69	-	85	46	-	-	20	48	7,90
	200	GG	11A	072H200N	291,06	289,69	-	90	60	50	-	20	50	8,00
	300	GG	11A	072H300N	291,06	289,69	-	100	86	55	-	20	57	13,00

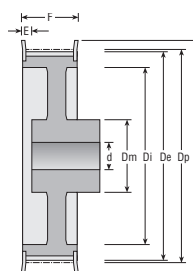

Figur 6CWF

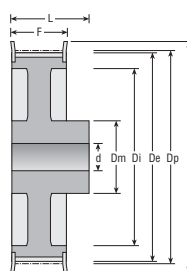

Figur 6WF

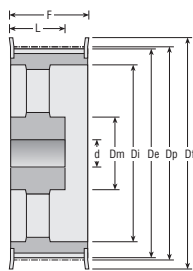

Figur 11AF

Z	Riemenbr.	Mat.	Fig.	Best. Nr.	Dp	De	Df	Dm	F	L	E	d	Max. Bohr.	Gewicht
84	100	GG	6A	084H100N	339,57	338,20	-	80	34	45	-	20	45	8,20
	150	GG	10A	084H150N	339,57	338,20	-	85	46	-	-	20	48	8,90
	200	GG	11A	084H200N	339,57	338,20	-	90	60	50	-	20	50	12,00
	300	GG	11A	084H300N	339,57	338,20	-	100	86	55	-	20	57	15,10
96	100	GG	6A	096H100N	388,08	386,71	-	80	34	45	-	20	45	9,90
	150	GG	10A	096H150N	388,08	386,71	-	85	46	-	-	20	48	10,10
	200	GG	11A	096H200N	388,08	386,71	-	90	60	50	-	20	50	13,60
	300	GG	11A	096H300N	388,08	386,71	-	100	86	55	-	20	57	18,20
120	100	GG	6A	120H100N	485,10	483,73	-	90	34	50	-	20	50	13,10
	150	GG	6A	120H150N	485,10	483,73	-	95	46	55	-	24	55	17,20
	200	GG	11A	120H200N	485,10	483,73	-	100	60	-	-	24	57	16,60
	300	GG	11A	120H300N	485,10	483,73	-	110	86	65	-	24	62	26,00