

Figur 1F

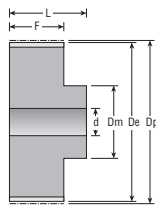

Figur 6

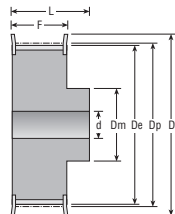

Figur 6F

Z	Riemenbr.	Mat.	Fig.	Best. Nr.	Dp	De	Df	Dm	Di	F	L	d	Gewicht
10	9	AL	1F	0103M009N	9,55	8,79	13,0	13,0	-	10,2	17,5	-	0,004
	15	AL	1F	0103M015N	9,55	8,79	13,0	13,0	-	17,0	26,0	-	0,006
12	9	AL	1F	0123M009N	11,46	10,70	15,0	15,0	-	10,2	17,5	-	0,006
	15	AL	1F	0123M015N	11,46	10,70	15,0	15,0	-	17,0	26,0	-	0,008
14	9	AL	1F	0143M009N	13,37	12,61	16,0	16,0	-	10,2	17,5	-	0,007
	15	AL	1F	0143M015N	13,37	12,61	16,0	16,0	-	17,0	26,0	-	0,010
15	9	AL	1F	0153M009N	14,32	13,56	17,5	17,5	-	10,2	17,5	-	0,008
	15	AL	1F	0153M015N	14,32	13,56	17,5	17,5	-	17,0	26,0	-	0,012
16	9	AL	6F	0163M009N	15,28	14,52	18,0	9,5	-	12,8	20,6	4,0	0,007
	15	AL	6F	0163M015N	15,28	14,52	18,0	9,5	-	19,5	26,0	4,0	0,010
18	9	AL	6F	0183M009N	17,19	16,43	19,5	10,0	-	12,8	20,6	6,0	0,008
	15	AL	6F	0183M015N	17,19	16,43	19,5	10,0	-	19,5	26,0	6,0	0,012
20	9	AL	6F	0203M009N	19,10	18,34	23,0	12,0	-	12,8	20,6	6,0	0,010
	15	AL	6F	0203M015N	19,10	18,34	23,0	12,0	-	19,5	26,0	6,0	0,014
21	9	AL	6F	0213M009N	20,05	19,29	25,0	13,0	-	12,8	20,6	6,0	0,013
	15	AL	6F	0213M015N	20,05	19,29	25,0	13,0	-	19,5	26,0	6,0	0,016
22	9	AL	6F	0223M009N	21,01	20,25	25,0	13,0	-	12,8	20,6	6,0	0,014
	15	AL	6F	0223M015N	21,01	20,25	25,0	13,0	-	19,5	26,0	6,0	0,018
24	9	AL	6F	0243M009N	22,92	22,16	25,0	13,0	-	12,8	20,6	6,0	0,016
	15	AL	6F	0243M015N	22,92	22,16	25,0	13,0	-	19,5	26,0	6,0	0,020
26	9	AL	6F	0263M009N	24,83	24,07	28,0	16,0	-	12,8	20,6	6,0	0,018
	15	AL	6F	0263M015N	24,83	24,07	28,0	16,0	-	19,5	26,0	6,0	0,027
28	9	AL	6F	0283M009N	26,74	25,98	32,0	18,0	-	12,8	20,6	6,0	0,024
	15	AL	6F	0283M015N	26,74	25,98	32,0	18,0	-	19,5	26,0	6,0	0,030
30	9	AL	6F	0303M009N	28,65	27,89	32,0	19,0	-	12,8	20,6	6,0	0,028
	15	AL	6F	0303M015N	28,65	27,89	32,0	19,0	-	19,5	26,0	6,0	0,035
32	9	AL	6F	0323M009N	30,56	29,80	36,0	22,0	-	12,8	20,6	6,0	0,032
	15	AL	6F	0323M015N	30,56	29,80	36,0	22,0	-	19,5	26,0	6,0	0,042
36	9	AL	6F	0363M009N	34,38	33,62	38,0	26,0	-	13,4	22,2	6,0	0,045
	15	AL	6F	0363M015N	34,38	33,62	38,0	26,0	-	20,0	30,0	6,0	0,060
40	9	AL	6F	0403M009N	38,20	37,44	42,0	28,0	-	13,4	22,2	6,0	0,055
	15	AL	6F	0403M015N	38,20	37,44	42,0	28,0	-	20,0	30,0	6,0	0,075
44	9	AL	6F	0443M009N	42,02	41,26	48,0	33,0	-	13,4	22,2	6,0	0,074
	15	AL	6F	0443M015N	42,02	41,26	48,0	33,0	-	20,0	30,0	6,0	0,100
48	9	AL	6	0483M009N	45,84	45,08	-	33,0	-	13,4	22,2	8,0	0,074
	15	AL	6	0483M015N	45,84	45,08	-	33,0	-	20,0	30,0	8,0	0,103
60	9	AL	6	0603M009N	57,30	56,54	-	33,0	-	13,4	22,2	8,0	0,106
	15	AL	6	0603M015N	57,30	56,54	-	33,0	-	20,0	30,0	8,0	0,150
72	9	AL	6	0723M009N	68,75	67,99	-	33,0	-	13,4	22,2	8,0	0,145
	15	AL	6	0723M015N	68,75	67,99	-	33,0	-	20,0	30,0	8,0	0,212

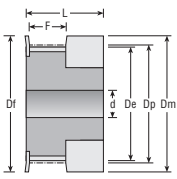

Figur 1F

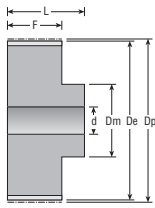

Figur 6

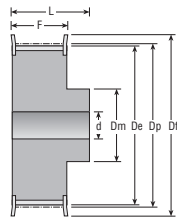

Figur 6F

Z	Riemenbr.	Mat.	Fig.	Best. Nr.	Dp	De	Df	Dm	Di	F	L	d	Gewicht
10	9	AL	1F	0103MR009N	9,55	8,79	13,0	13,0	-	10,2	17,5	-	0,004
	15	AL	1F	0103MR015N	9,55	8,79	13,0	13,0	-	17,0	26,0	-	0,006
12	9	AL	1F	0123MR009N	11,46	10,70	15,0	15,0	-	10,2	17,5	-	0,006
	15	AL	1F	0123MR015N	11,46	10,70	15,0	15,0	-	17,0	26,0	-	0,008
14	9	AL	1F	0143MR009N	13,37	12,61	16,0	16,0	-	10,2	17,5	-	0,007
	15	AL	1F	0143MR015N	13,37	12,61	16,0	16,0	-	17,0	26,0	-	0,010
15	9	AL	1F	0153MR009N	14,32	13,56	17,5	17,5	-	10,2	17,5	-	0,008
	15	AL	1F	0153MR015N	14,32	13,56	17,5	17,5	-	17,0	26,0	-	0,012
16	9	AL	6F	0163MR009N	15,28	14,52	18,0	9,5	-	12,8	20,6	4,0	0,007
	15	AL	6F	0163MR015N	15,28	14,52	18,0	9,5	-	19,5	26,0	4,0	0,010
18	9	AL	6F	0183MR009N	17,19	16,43	19,5	10,0	-	12,8	20,6	6,0	0,008
	15	AL	6F	0183MR015N	17,19	16,43	19,5	10,0	-	19,5	26,0	6,0	0,012
20	9	AL	6F	0203MR009N	19,10	18,34	23,0	12,0	-	12,8	20,6	6,0	0,010
	15	AL	6F	0203MR015N	19,10	18,34	23,0	12,0	-	19,5	26,0	6,0	0,014
21	9	AL	6F	0213MR009N	20,05	19,29	25,0	13,0	-	12,8	20,6	6,0	0,013
	15	AL	6F	0213MR015N	20,05	19,29	25,0	13,0	-	19,5	26,0	6,0	0,016
22	9	AL	6F	0223MR009N	21,01	20,25	25,0	13,0	-	12,8	20,6	6,0	0,014
	15	AL	6F	0223MR015N	21,01	20,25	25,0	13,0	-	19,5	26,0	6,0	0,018
24	9	AL	6F	0243MR009N	22,92	22,16	25,0	13,0	-	12,8	20,6	6,0	0,016
	15	AL	6F	0243MR015N	22,92	22,16	25,0	13,0	-	19,5	26,0	6,0	0,020
26	9	AL	6F	0263MR009N	24,83	24,07	28,0	16,0	-	12,8	20,6	6,0	0,018
	15	AL	6F	0263MR015N	24,83	24,07	28,0	16,0	-	19,5	26,0	6,0	0,027
28	9	AL	6F	0283MR009N	26,74	25,98	32,0	18,0	-	12,8	20,6	6,0	0,024
	15	AL	6F	0283MR015N	26,74	25,98	32,0	18,0	-	19,5	26,0	6,0	0,030
30	9	AL	6F	0303MR009N	28,65	27,89	32,0	19,0	-	12,8	20,6	6,0	0,028
	15	AL	6F	0303MR015N	28,65	27,89	32,0	19,0	-	19,5	26,0	6,0	0,035
32	9	AL	6F	0323MR009N	30,56	29,80	36,0	22,0	-	12,8	20,6	6,0	0,032
	15	AL	6F	0323MR015N	30,56	29,80	36,0	22,0	-	19,5	26,0	6,0	0,042
36	9	AL	6F	0363MR009N	34,38	33,62	38,0	26,0	-	13,4	22,2	6,0	0,045
	15	AL	6F	0363MR015N	34,38	33,62	38,0	26,0	-	20,0	30,0	6,0	0,060
40	9	AL	6F	0403MR009N	38,20	37,44	42,0	28,0	-	13,4	22,2	6,0	0,055
	15	AL	6F	0403MR015N	38,20	37,44	42,0	28,0	-	20,0	30,0	6,0	0,075
44	9	AL	6F	0443MR009N	42,02	41,26	48,0	33,0	-	13,4	22,2	6,0	0,074
	15	AL	6F	0443MR015N	42,02	41,26	48,0	33,0	-	20,0	30,0	6,0	0,100
48	9	AL	6	0483MR009N	45,84	45,08	-	33,0	-	13,4	22,2	8,0	0,074
	15	AL	6	0483MR015N	45,84	45,08	-	33,0	-	20,0	30,0	8,0	0,103
60	9	AL	6	0603MR009N	57,30	56,54	-	33,0	-	13,4	22,2	8,0	0,106
	15	AL	6	0603MR015N	57,30	56,54	-	33,0	-	20,0	30,0	8,0	0,150
72	9	AL	6	0723MR009N	68,75	67,99	-	33,0	-	13,4	22,2	8,0	0,145
	15	AL	6	0723MR015N	68,75	67,99	-	33,0	-	20,0	30,0	8,0	0,212

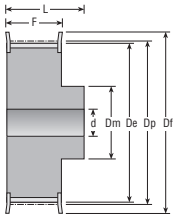

Figur 6F

Z	Riemenbr.	Mat.	Fig.	Best. Nr.	Dp	De	Df	Dm	Di	F	L	d	Gewicht
12	9	ST	6F	0125M009N	19,10	17,96	25,0	13,0	-	14,5	20,0	4,0	0,028
	15	ST	6F	0125M015N	19,10	17,96	25,0	13,0	-	20,5	26,0	4,0	0,034
	25	ST	6F	0125M025N	19,10	17,96	25,0	13,0	-	30,5	36,0	4,0	0,050
14	9	ST	6F	0145M009N	22,28	21,14	25,0	13,0	-	14,5	20,0	6,0	0,034
	15	ST	6F	0145M015N	22,28	21,14	25,0	13,0	-	20,5	26,0	6,0	0,046
	25	ST	6F	0145M025N	22,28	21,14	25,0	13,0	-	30,5	36,0	6,0	0,070
15	9	ST	6F	0155M009N	23,87	22,73	28,0	16,0	-	14,5	20,0	6,0	0,042
	15	ST	6F	0155M015N	23,87	22,73	28,0	16,0	-	20,5	26,0	6,0	0,056
	25	ST	6F	0155M025N	23,87	22,73	28,0	16,0	-	30,5	36,0	6,0	0,080
16	9	ST	6F	0165M009N	25,46	24,32	28,0	16,0	-	14,5	20,0	6,0	0,050
	15	ST	6F	0165M015N	25,46	24,32	28,0	16,0	-	20,5	26,0	6,0	0,064
	25	ST	6F	0165M025N	25,46	24,32	28,0	16,0	-	30,5	36,0	6,0	0,100
18	9	ST	6F	0185M009N	28,65	27,51	32,0	19,0	-	14,5	20,0	6,0	0,070
	15	ST	6F	0185M015N	28,65	27,51	32,0	19,0	-	20,5	26,0	6,0	0,086
	25	ST	6F	0185M025N	28,65	27,51	32,0	19,0	-	30,5	36,0	6,0	0,120
20	9	ST	6F	0205M009N	31,83	30,69	36,0	23,0	-	14,5	22,5	6,0	0,094
	15	ST	6F	0205M015N	31,83	30,69	36,0	23,0	-	20,5	26,0	6,0	0,112
	25	ST	6F	0205M025N	31,83	30,69	36,0	23,0	-	30,5	36,0	6,0	0,160
21	9	ST	6F	0215M009N	33,42	32,28	38,0	24,0	-	14,5	22,5	6,0	0,110
	15	ST	6F	0215M015N	33,42	32,28	38,0	24,0	-	20,5	26,0	6,0	0,130
	25	ST	6F	0215M025N	33,42	32,28	38,0	24,0	-	30,5	38,0	6,0	0,190
22	9	ST	6F	0225M009N	35,01	33,87	38,0	25,5	-	14,5	22,5	6,0	0,118
	15	ST	6F	0225M015N	35,01	33,87	38,0	25,5	-	20,5	26,0	6,0	0,140
	25	ST	6F	0225M025N	35,01	33,87	38,0	25,5	-	30,5	38,0	6,0	0,210
24	9	ST	6F	0245M009N	38,20	37,06	42,0	27,0	-	14,5	22,5	6,0	0,145
	15	ST	6F	0245M015N	38,20	37,06	42,0	27,0	-	20,5	28,0	6,0	0,180
	25	ST	6F	0245M025N	38,20	37,06	42,0	27,0	-	30,5	38,0	6,0	0,250
26	9	ST	6F	0265M009N	41,38	40,24	44,0	30,0	-	14,5	22,5	6,0	0,170
	15	ST	6F	0265M015N	41,38	40,24	44,0	30,0	-	20,5	28,0	6,0	0,220
	25	ST	6F	0265M025N	41,38	40,24	44,0	30,0	-	30,5	38,0	6,0	0,300
28	9	ST	6F	0285M009N	44,56	43,42	48,0	30,5	-	14,5	22,5	6,0	0,200
	15	ST	6F	0285M015N	44,56	43,42	48,0	30,5	-	20,5	28,0	6,0	0,250
	25	ST	6F	0285M025N	44,56	43,42	48,0	30,5	-	30,5	38,0	6,0	0,350
30	9	ST	6F	0305M009N	47,75	46,60	51,0	35,0	-	14,5	22,5	6,0	0,236
	15	ST	6F	0305M015N	47,75	46,60	51,0	35,0	-	20,5	28,0	6,0	0,300
	25	ST	6F	0305M025N	47,75	46,60	51,0	35,0	-	30,5	38,0	6,0	0,420
32	9	ST	6F	0325M009N	50,93	49,79	54,0	38,0	-	14,5	22,5	8,0	0,270
	15	ST	6F	0325M015N	50,93	49,79	54,0	38,0	-	20,5	28,0	8,0	0,350
	25	ST	6F	0325M025N	50,93	49,79	54,0	38,0	-	30,5	38,0	8,0	0,480
36	9	ST	6F	0365M009N	57,30	56,16	60,0	38,0	-	14,5	22,5	8,0	0,324
	15	ST	6F	0365M015N	57,30	56,16	60,0	38,0	-	20,5	28,0	8,0	0,520
	25	ST	6F	0365M025N	57,30	56,16	60,0	38,0	-	30,5	38,0	8,0	0,590
40	9	ST	6F	0405M009N	63,66	62,52	71,00	38,0	-	14,5	22,5	8,0	0,400
	15	ST	6F	0405M015N	63,66	62,52	71,00	38,0	-	20,5	28,0	8,0	0,426
	25	ST	6F	0405M025N	63,66	62,52	71,00	38,0	-	30,5	38,0	8,0	0,740

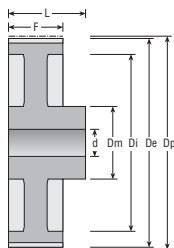

Figur 6W

Z	Riemenbr.	Mat.	Fig.	Best. Nr.	Dp	De	Df	Dm	Di	F	L	d	Gewicht
44	9	AL	6W	0445M009N	70,03	68,89	-	38,0	-	14,5	25,5	8,0	0,170
	15	AL	6W	0445M015N	70,03	68,89	-	38,0	-	20,5	30,0	8,0	0,225
	25	AL	6W	0445M025N	70,03	68,89	-	38,0	-	30,5	40,0	8,0	0,320
48	9	AL	6W	0485M009N	76,39	75,25	-	45,0	-	14,5	25,5	8,0	0,182
	15	AL	6W	0485M015N	76,39	75,25	-	38,0	-	20,5	30,0	8,0	0,187
	25	AL	6W	0485M025N	76,39	75,25	-	38,0	-	30,5	40,0	8,0	0,275
60	9	AL	6W	0605M009N	95,49	94,35	-	45,0	-	14,5	25,5	8,0	0,230
	15	AL	6W	0605M015N	95,49	94,35	-	50,0	-	20,5	30,0	8,0	0,305
	25	AL	6W	0605M025N	95,49	94,35	-	50,0	-	30,5	40,0	8,0	0,435
72	9	AL	6W	0725M009N	114,59	113,45	-	45,0	-	14,5	25,5	8,0	0,270
	15	AL	6W	0725M015N	114,59	113,45	-	50,0	-	20,5	30,0	8,0	0,375
	25	AL	6W	0725M025N	114,59	113,45	-	50,0	-	30,5	40,0	8,0	0,525

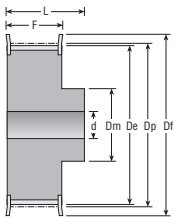

Figur 6F

Z	Riemenbr.	Mat.	Fig.	Best. Nr.	Dp	De	Df	Dm	Di	F	L	d	Gewicht
12	9	ST	6F	0125MR009N	19,10	17,96	25,0	13,0	-	14,5	20,0	4,0	0,028
	15	ST	6F	0125MR015N	19,10	17,96	25,0	13,0	-	20,5	26,0	4,0	0,034
	25	ST	6F	0125MR025N	19,10	17,96	25,0	13,0	-	30,5	36,0	4,0	0,050
14	9	ST	6F	0145MR009N	22,28	21,14	25,0	13,0	-	14,5	20,0	6,0	0,034
	15	ST	6F	0145MR015N	22,28	21,14	25,0	13,0	-	20,5	26,0	6,0	0,046
	25	ST	6F	0145MR025N	22,28	21,14	25,0	13,0	-	30,5	36,0	6,0	0,070
15	9	ST	6F	0155MR009N	23,87	22,73	28,0	16,0	-	14,5	20,0	6,0	0,042
	15	ST	6F	0155MR015N	23,87	22,73	28,0	16,0	-	20,5	26,0	6,0	0,056
	25	ST	6F	0155MR025N	23,87	22,73	28,0	16,0	-	30,5	36,0	6,0	0,080
16	9	ST	6F	0165MR009N	25,46	24,32	28,0	16,0	-	14,5	20,0	6,0	0,050
	15	ST	6F	0165MR015N	25,46	24,32	28,0	16,0	-	20,5	26,0	6,0	0,064
	25	ST	6F	0165MR025N	25,46	24,32	28,0	16,0	-	30,5	36,0	6,0	0,100
18	9	ST	6F	0185MR009N	28,65	27,51	32,0	19,0	-	14,5	20,0	6,0	0,070
	15	ST	6F	0185MR015N	28,65	27,51	32,0	19,0	-	20,5	26,0	6,0	0,086
	25	ST	6F	0185MR025N	28,65	27,51	32,0	19,0	-	30,5	36,0	6,0	0,120
20	9	ST	6F	0205MR009N	31,83	30,69	36,0	23,0	-	14,5	22,5	6,0	0,094
	15	ST	6F	0205MR015N	31,83	30,69	36,0	23,0	-	20,5	26,0	6,0	0,112
	25	ST	6F	0205MR025N	31,83	30,69	36,0	23,0	-	30,5	36,0	6,0	0,160
21	9	ST	6F	0215MR009N	33,42	32,28	38,0	24,0	-	14,5	22,5	6,0	0,110
	15	ST	6F	0215MR015N	33,42	32,28	38,0	24,0	-	20,5	26,0	6,0	0,130
	25	ST	6F	0215MR025N	33,42	32,28	38,0	24,0	-	30,5	38,0	6,0	0,190
22	9	ST	6F	0225MR009N	35,01	33,87	38,0	25,5	-	14,5	22,5	6,0	0,118
	15	ST	6F	0225MR015N	35,01	33,87	38,0	25,5	-	20,5	26,0	6,0	0,140
	25	ST	6F	0225MR025N	35,01	33,87	38,0	25,5	-	30,5	38,0	6,0	0,210
24	9	ST	6F	0245MR009N	38,20	37,06	42,0	27,0	-	14,5	22,5	6,0	0,145
	15	ST	6F	0245MR015N	38,20	37,06	42,0	27,0	-	20,5	28,0	6,0	0,180
	25	ST	6F	0245MR025N	38,20	37,06	42,0	27,0	-	30,5	38,0	6,0	0,250
26	9	ST	6F	0265MR009N	41,38	40,24	44,0	30,0	-	14,5	22,5	6,0	0,170
	15	ST	6F	0265MR015N	41,38	40,24	44,0	30,0	-	20,5	28,0	6,0	0,220
	25	ST	6F	0265MR025N	41,38	40,24	44,0	30,0	-	30,5	38,0	6,0	0,300
28	9	ST	6F	0285MR009N	44,56	43,42	48,0	30,5	-	14,5	22,5	6,0	0,200
	15	ST	6F	0285MR015N	44,56	43,42	48,0	30,5	-	20,5	28,0	6,0	0,250
	25	ST	6F	0285MR025N	44,56	43,42	48,0	30,5	-	30,5	38,0	6,0	0,350
30	9	ST	6F	0305MR009N	47,75	46,60	51,0	35,0	-	14,5	22,5	6,0	0,236
	15	ST	6F	0305MR015N	47,75	46,60	51,0	35,0	-	20,5	28,0	6,0	0,300
	25	ST	6F	0305MR025N	47,75	46,60	51,0	35,0	-	30,5	38,0	6,0	0,420
32	9	ST	6F	0325MR009N	50,93	49,79	54,0	38,0	-	14,5	22,5	8,0	0,270
	15	ST	6F	0325MR015N	50,93	49,79	54,0	38,0	-	20,5	28,0	8,0	0,350
	25	ST	6F	0325MR025N	50,93	49,79	54,0	38,0	-	30,5	38,0	8,0	0,480
36	9	ST	6F	0365MR009N	57,30	56,16	60,0	38,0	-	14,5	22,5	8,0	0,324
	15	ST	6F	0365MR015N	57,30	56,16	60,0	38,0	-	20,5	28,0	8,0	0,520
	25	ST	6F	0365MR025N	57,30	56,16	60,0	38,0	-	30,5	38,0	8,0	0,590
40	9	ST	6F	0405MR009N	63,66	62,52	71,00	38,0	-	14,5	22,5	8,0	0,400
	15	ST	6F	0405MR015N	63,66	62,52	71,00	38,0	-	20,5	28,0	8,0	0,426
	25	ST	6F	0405MR025N	63,66	62,52	71,00	38,0	-	30,5	38,0	8,0	0,740

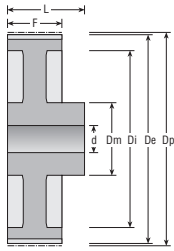

Figur 6W

Z	Riemenbr.	Mat.	Fig.	Best. Nr.	Dp	De	Df	Dm	Di	F	L	d	Gewicht
44	9	AL	6W	0445MR009N	70,03	68,89	-	38,0	-	14,5	25,5	8,0	0,170
	15	AL	6W	0445MR015N	70,03	68,89	-	38,0	-	20,5	30,0	8,0	0,225
	25	AL	6W	0445MR025N	70,03	68,89	-	38,0	-	30,5	40,0	8,0	0,320
48	9	AL	6W	0485MR009N	76,39	75,25	-	45,0	-	14,5	25,5	8,0	0,182
	15	AL	6W	0485MR015N	76,39	75,25	-	38,0	-	20,5	30,0	8,0	0,187
	25	AL	6W	0485MR025N	76,39	75,25	-	38,0	-	30,5	40,0	8,0	0,275
60	9	AL	6W	0605MR009N	95,49	94,35	-	45,0	-	14,5	25,5	8,0	0,230
	15	AL	6W	0605MR015N	95,49	94,35	-	50,0	-	20,5	30,0	8,0	0,305
	25	AL	6W	0605MR025N	95,49	94,35	-	50,0	-	30,5	40,0	8,0	0,435
72	9	AL	6W	0725MR009N	114,59	113,45	-	45,0	-	14,5	25,5	8,0	0,270
	15	AL	6W	0725MR015N	114,59	113,45	-	50,0	-	20,5	30,0	8,0	0,375
	25	AL	6W	0725MR025N	114,59	113,45	-	50,0	-	30,5	40,0	8,0	0,525

8M HTD®-GT®

VORGEBOHRT

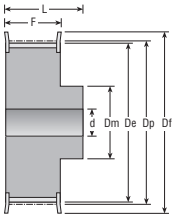

Figur 6F

Z	Riemenbr.	Mat.	Fig.	Best. Nr.	Dp	De	Df	Dm	Di	F	L	d	Gewicht
22	20	ST	6F	0228M020N	56,02	54,65	60,0	43	-	28	38	12	0,54
	30	ST	6F	0228M030N	56,02	54,65	60,0	43	-	38	48	12	0,69
	50	ST	6F	0228M050N	56,02	54,65	60,0	43	-	60	70	12	1,00
	85	ST	6F	0228M085N	56,02	54,65	60,0	43	-	95	105	12	1,55
24	20	ST	6F	0248M020N	61,12	59,75	66,0	45	-	28	38	12	0,65
	30	ST	6F	0248M030N	61,12	59,75	66,0	45	-	38	48	12	0,84
	50	ST	6F	0248M050N	61,12	59,75	66,0	45	-	60	70	12	1,23
	85	ST	6F	0248M085N	61,12	59,75	66,0	45	-	95	105	12	1,90
26	20	ST	6F	0268M020N	66,21	64,84	71,0	50	-	28	38	12	0,80
	30	ST	6F	0268M030N	66,21	64,84	71,0	50	-	38	48	12	1,00
	50	ST	6F	0268M050N	66,21	64,84	71,0	50	-	60	70	12	1,50
	85	ST	6F	0268M085N	66,21	64,84	71,0	50	-	95	105	12	2,25
28	20	ST	6F	0288M020N	71,30	70,08	75,0	50	-	28	38	15	0,87
	30	ST	6F	0288M030N	71,30	70,08	75,0	50	-	38	48	15	1,12
	50	ST	6F	0288M050N	71,30	70,08	75,0	50	-	60	70	15	1,67
	85	ST	6F	0288M085N	71,30	70,08	75,0	50	-	95	105	15	2,55
30	20	ST	6F	0308M020N	76,39	75,13	83,0	55	-	28	38	15	1,02
	30	ST	6F	0308M030N	76,39	75,13	83,0	55	-	38	48	15	1,32
	50	ST	6F	0308M050N	76,39	75,13	83,0	55	-	60	70	15	1,97
	85	ST	6F	0308M085N	76,39	75,13	83,0	55	-	95	105	15	3,00
32	20	ST	6F	0328M020N	81,49	80,16	87,0	60	-	28	38	15	1,20
	30	ST	6F	0328M030N	81,49	80,16	87,0	60	-	38	48	15	1,53
	50	ST	6F	0328M050N	81,49	80,16	87,0	60	-	60	70	15	2,27
	85	ST	6F	0328M085N	81,49	80,16	87,0	60	-	95	105	15	3,57
34	20	ST	6F	0348M020N	86,58	85,22	91,0	70	-	28	38	15	1,40
	30	ST	6F	0348M030N	86,58	85,22	91,0	70	-	38	48	15	1,80
	50	ST	6F	0348M050N	86,58	85,22	91,0	70	-	60	70	15	2,69
	85	ST	6F	0348M085N	86,58	85,22	91,0	70	-	95	105	15	4,00
36	20	ST	6F	0368M020N	91,67	90,30	98,5	70	-	28	38	15	1,55
	30	ST	6F	0368M030N	91,67	90,30	98,5	70	-	38	48	15	1,99
	50	ST	6F	0368M050N	91,67	90,30	98,5	70	-	60	70	15	2,97
	85	ST	6F	0368M085N	91,67	90,30	98,5	70	-	95	105	15	4,50
38	20	ST	6F	0388M020N	96,77	95,39	103,0	75	-	28	38	15	1,65
	30	ST	6F	0388M030N	96,77	95,39	103,0	75	-	38	48	15	2,27
	50	ST	6F	0388M050N	96,77	95,39	103,0	75	-	60	70	15	3,23
	85	ST	6F	0388M085N	96,77	95,39	103,0	75	-	95	105	15	4,90
40	20	GG	6F	0408M020N	101,86	100,49	106,0	75	-	28	38	15	1,74
	30	GG	6F	0408M030N	101,86	100,49	106,0	75	-	38	48	15	2,40
	50	GG	6F	0408M050N	101,86	100,49	106,0	75	-	60	70	18	3,50
	85	GG	6F	0408M085N	101,86	100,49	106,0	75	-	95	105	18	5,20
44	20	GG	6F	0448M020N	112,05	110,67	119,0	75	-	28	38	15	2,10
	30	GG	6F	0448M030N	112,05	110,67	119,0	75	-	38	48	15	2,80
	50	GG	6F	0448M050N	112,05	110,67	119,0	75	-	60	70	18	3,90
	85	GG	6F	0448M085N	112,05	110,67	119,0	75	-	95	105	18	6,60

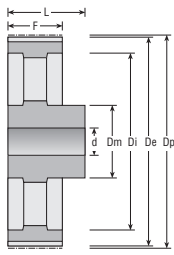

Figur 6A

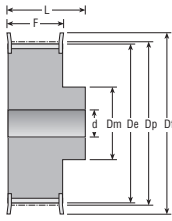

Figur 6F

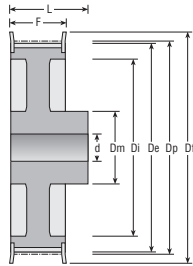

Figur 6WF

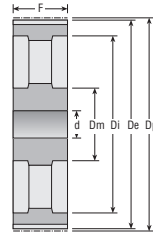

Figur 10A

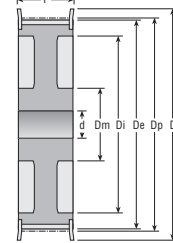

Figur 10WF

Z	Riemenbr.	Mat.	Fig.	Best. Nr.	Dp	De	Df	Dm	Di	F	L	d	Gewicht
48	20	GG	6F	0488M020N	122,23	120,86	127,0	75	-	28	38	15	2,44
	30	GG	6F	0488M030N	122,23	120,86	127,0	75	-	38	48	15	3,20
	50	GG	6F	0488M050N	122,23	120,86	127,0	80	-	60	70	18	4,30
	85	GG	6F	0488M085N	122,23	120,86	127,0	80	-	95	105	18	7,60
56	20	GG	6WF	0568M020N	142,60	141,23	148,0	80	117	28	38	15	2,60
	30	GG	6WF	0568M030N	142,60	141,23	148,0	90	117	38	48	15	3,60
	50	GG	10WF	0568M050N	142,60	141,23	148,0	90	117	60	60	18	5,00
	85	GG	6F	0568M085N	142,60	141,23	148,0	80	-	95	105	20	9,80
64	20	GG	6WF	0648M020N	162,97	161,60	168,0	80	137	28	38	15	2,90
	30	GG	6WF	0648M030N	162,97	161,60	168,0	90	137	38	48	15	4,30
	50	GG	10WF	0648M050N	162,97	161,60	168,0	100	137	60	60	18	5,60
	85	GG	10WF	0648M085N	162,97	161,60	168,0	100	137	95	95	20	10,40
72	20	GG	6WF	0728M020N	183,35	181,97	192,0	80	158	28	38	15	3,10
	30	GG	6WF	0728M030N	183,35	181,97	192,0	95	158	38	48	15	4,80
	50	GG	10WF	0728M050N	183,35	181,97	192,0	100	158	60	60	18	6,80
	85	GG	10WF	0728M085N	183,35	181,97	192,0	110	158	95	95	20	11,40
80	20	GG	6A	0808M020N	203,72	202,35	-	90	180	28	38	15	3,80
	30	GG	6A	0808M030N	203,72	202,35	-	100	180	38	48	15	5,10
	50	GG	10A	0808M050N	203,72	202,35	-	110	180	60	60	18	6,90
	85	GG	10A	0808M085N	203,72	202,35	-	110	180	95	95	20	11,10
90	20	GG	6A	0908M020N	229,18	227,81	-	90	204	28	38	15	4,20
	30	GG	6A	0908M030N	229,18	227,81	-	100	204	38	48	15	5,70
	50	GG	10A	0908M050N	229,18	227,81	-	110	204	60	60	18	8,60
	85	GG	10A	0908M085N	229,18	227,81	-	110	204	95	95	20	13,20
112	20	GG	6A	1128M020N	285,21	283,83	-	90	260	28	38	18	5,20
	30	GG	6A	1128M030N	285,21	283,83	-	100	260	38	48	18	6,80
	50	GG	10A	1128M050N	285,21	283,83	-	110	260	60	60	18	9,60
	85	GG	10A	1128M085N	285,21	283,83	-	110	260	95	95	24	16,30
144	20	GG	6A	1448M020N	366,69	365,32	-	90	341	28	38	20	7,50
	30	GG	6A	1448M030N	366,69	365,32	-	100	341	38	48	20	9,30
	50	GG	10A	1448M050N	366,69	365,32	-	110	341	60	60	20	13,80
	85	GG	10A	1448M085N	366,69	365,32	-	120	341	95	95	24	21,50
168	20	GG	6A	1688M020N	427,81	426,44	-	100	402	28	38	20	10,00
	30	GG	6A	1688M030N	427,81	426,44	-	100	402	38	48	20	11,40
	50	GG	10A	1688M050N	427,81	426,44	-	120	402	60	60	20	16,00
	85	GG	10A	1688M085N	427,81	426,44	-	120	402	95	95	24	26,10
192	20	GG	6A	1928M020N	488,92	487,55	-	100	463	28	38	20	14,40
	30	GG	6A	1928M030N	488,92	487,55	-	100	463	38	48	20	16,00
	50	GG	10A	1928M050N	488,92	487,55	-	130	463	60	60	20	22,40
	85	GG	10A	1928M085N	488,92	487,55	-	130	463	95	95	24	30,60

14M HTD®-GT®

VORGEBOHRT

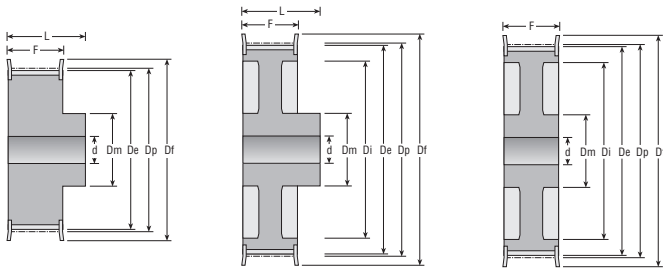

Figur 6F

Figur 6WF

Figur 10WF

Z	Riemenbr.	Mat.	Fig.	Best. Nr.	Dp	De	Df	Dm	Di	F	L	d	Gewicht
28	40	GG	6F	02814M040N	124,78	122,12	127	100	-	54	69	24	4,73
	55	GG	6F	02814M055N	124,78	122,12	127	100	-	70	85	24	5,60
	85	GG	6F	02814M085N	124,78	122,12	127	100	-	102	117	24	7,70
	115	GG	6F	02814M115N	124,78	122,12	127	100	-	133	148	32	9,20
	170	GG	6F	02814M170N	124,78	122,12	127	100	-	187	202	32	13,80
29	40	GG	6F	02914M040N	129,23	126,57	138	100	-	54	69	24	5,09
	55	GG	6F	02914M055N	129,23	126,57	138	100	-	70	85	24	6,10
	85	GG	6F	02914M085N	129,23	126,57	138	100	-	102	117	24	8,40
	115	GG	6F	02914M115N	129,23	126,57	138	100	-	133	148	32	10,20
	170	GG	6F	02914M170N	129,23	126,57	138	100	-	187	202	32	14,20
30	40	GG	6F	03014M040N	133,69	130,99	138	100	-	54	69	24	5,45
	55	GG	6F	03014M055N	133,69	130,99	138	100	-	70	85	24	6,60
	85	GG	6F	03014M085N	133,69	130,99	138	100	-	102	117	24	9,10
	115	GG	6F	03014M115N	133,69	130,99	138	100	-	133	148	32	11,20
	170	GG	6F	03014M170N	133,69	130,99	138	100	-	187	202	32	15,60
32	40	GG	6F	03214M040N	142,60	139,88	154	100	-	54	69	24	6,17
	55	GG	6F	03214M055N	142,60	139,88	154	100	-	70	85	24	7,60
	85	GG	6F	03214M085N	142,60	139,88	154	100	-	102	117	24	10,50
	115	GG	6F	03214M115N	142,60	139,88	154	100	-	133	148	32	13,20
	170	GG	6F	03214M170N	142,60	139,88	154	100	-	187	202	32	18,10
34	40	GG	6F	03414M040N	151,52	148,79	160	100	-	54	69	24	6,88
	55	GG	6F	03414M055N	151,52	148,79	160	100	-	70	85	24	8,60
	85	GG	6F	03414M085N	151,52	148,79	160	100	-	102	117	24	11,90
	115	GG	6F	03414M115N	151,52	148,79	160	100	-	133	148	32	14,80
	170	GG	6F	03414M170N	151,52	148,79	160	100	-	187	202	32	20,40
36	40	GG	6F	03614M040N	160,43	157,68	168	100	-	54	69	24	7,60
	55	GG	6F	03614M055N	160,43	157,68	168	100	-	70	85	24	9,60
	85	GG	6F	03614M085N	160,43	157,68	168	100	-	102	117	32	13,20
	115	GG	6F	03614M115N	160,43	157,68	168	120	-	133	148	32	16,60
	170	GG	6F	03614M170N	160,43	157,68	168	120	-	187	202	32	23,50
38	40	GG	6F	03814M040N	169,34	166,60	183	120	-	54	69	24	8,28
	55	GG	6F	03814M055N	169,34	166,60	183	120	-	70	85	24	10,80
	85	GG	6F	03814M085N	169,34	166,60	183	120	-	102	117	32	15,15
	115	GG	6F	03814M115N	169,34	166,60	183	120	-	133	148	32	19,20
	170	GG	6F	03814M170N	169,34	166,60	183	135	-	187	202	32	26,50
40	40	GG	6F	04014M040N	178,25	175,49	188	120	-	54	69	24	9,26
	55	GG	6F	04014M055N	178,25	175,49	188	120	-	70	85	24	11,20
	85	GG	6F	04014M085N	178,25	175,49	188	135	-	102	117	32	17,10
	115	GG	6F	04014M115N	178,25	175,49	188	135	-	133	148	32	20,56
	170	GG	6F	04014M170N	178,25	175,49	188	140	-	187	202	32	30,10
44	40	GG	6F	04414M040N	196,08	193,28	211	120	-	54	69	24	10,32
	55	GG	6F	04414M055N	196,08	193,28	211	120	-	70	85	24	12,50
	85	GG	6F	04414M085N	196,08	193,28	211	135	-	102	117	32	23,30
	115	GG	6F	04414M115N	196,08	193,28	211	140	-	133	148	32	28,00
	170	GG	6F	04414M170N	196,08	193,28	211	160	-	187	202	32	37,80
48	40	GG	6WF	04814M040N	213,90	211,11	226	135	172	54	69	24	11,50
	55	GG	10WF	04814M055N	213,90	211,11	226	135	172	70	70	24	13,70
	85	GG	6F	04814M085N	213,90	211,11	226	150	-	102	117	32	25,00
	115	GG	6F	04814M115N	213,90	211,11	226	150	-	133	148	32	35,00
	170	GG	6F	04814M170N	213,90	211,11	226	160	-	187	202	32	44,50

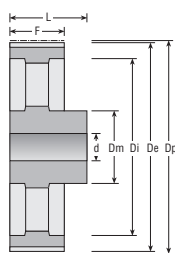

Figur 6A

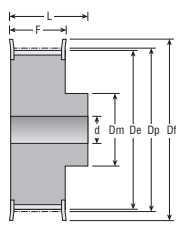

Figur 6F

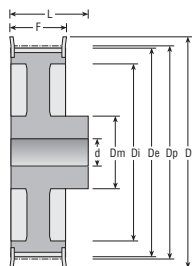

Figur 6WF

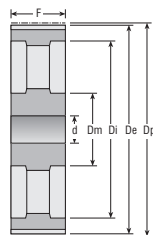

Figur 10A

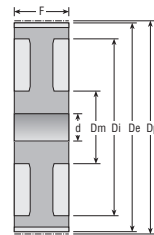

Figur 10W

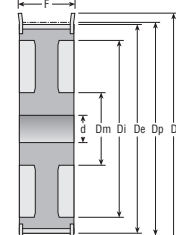

Figur 10WF

Z	Riemenbr.	Mat.	Fig.	Best. Nr.	Dp	De	Df	Dm	Di	F	L	d	Gewicht
56	40	GG	6WF	05614M040N	249,55	246,76	256	135	207	54	69	28	13,05
	55	GG	10WF	05614M055N	249,55	246,76	256	135	207	70	70	28	14,50
	85	GG	10WF	05614M085N	249,55	246,76	256	150	207	102	102	32	25,00
	115	GG	6F	05614M115N	249,55	246,76	256	150	-	133	148	32	27,50
	170	GG	6F	05614M170N	249,55	246,76	256	160	-	187	202	32	61,00
64	40	GG	6WF	06414M040N	285,21	282,41	296	135	242	54	69	28	14,40
	55	GG	10WF	06414M055N	285,21	282,41	296	135	242	70	70	28	15,60
	85	GG	10WF	06414M085N	285,21	282,41	296	150	242	102	102	32	28,20
	115	GG	10WF	06414M115N	285,21	282,41	296	150	242	133	133	32	36,80
	170	GG	6F	06414M170N	285,21	282,41	296	180	-	187	202	32	81,00
72	40	GG	6A	07214M040N	320,86	318,06	-	135	278	54	69	28	16,90
	55	GG	10A	07214M055N	320,86	318,06	-	135	278	70	70	28	18,50
	85	GG	10A	07214M085N	320,86	318,06	-	150	278	102	102	32	28,80
	115	GG	10A	07214M115N	320,86	318,06	-	150	278	133	133	32	32,83
	170	GG	10W	07214M170N	320,86	318,06	-	180	278	187	187	32	61,40
80	40	GG	6A	08014M040N	356,51	353,71	-	135	314	54	69	28	18,50
	55	GG	10A	08014M055N	356,51	353,71	-	135	314	70	70	28	20,00
	85	GG	10A	08014M085N	356,51	353,71	-	150	314	102	102	32	30,10
	115	GG	10A	08014M115N	356,51	353,71	-	150	314	133	133	32	35,55
	170	GG	10W	08014M170N	356,51	353,71	-	180	314	187	187	32	65,00
90	40	GG	6A	09014M040N	401,07	398,28	-	135	358	54	69	28	20,00
	55	GG	10A	09014M055N	401,07	398,28	-	135	358	70	70	28	22,60
	85	GG	10A	09014M085N	401,07	398,28	-	150	358	102	102	32	33,00
	115	GG	10A	09014M115N	401,07	398,28	-	150	358	133	133	32	41,00
	170	GG	10A	09014M170N	401,07	398,28	-	180	358	187	187	38	68,00
112	40	GG	6A	11214M040N	499,11	496,32	-	135	456	54	69	28	26,70
	55	GG	10A	11214M055N	499,11	496,32	-	135	456	70	70	28	29,50
	85	GG	10A	11214M085N	499,11	496,32	-	150	456	102	102	32	41,80
	115	GG	10A	11214M115N	499,11	496,32	-	150	456	133	133	32	54,40
	170	GG	10A	11214M170N	499,11	496,32	-	200	456	187	187	38	87,50
144	40	GG	6A	14414M040N	641,71	638,92	-	135	600	54	69	28	35,00
	55	GG	10A	14414M055N	641,71	638,92	-	135	600	70	70	28	39,00
	85	GG	10A	14414M085N	641,71	638,92	-	150	600	102	102	32	52,40
	115	GG	10A	14414M115N	641,71	638,92	-	165	600	133	133	32	67,80
	170	GG	10A	14414M170N	641,71	638,92	-	220	600	187	187	38	114,80
168	40	GG	6A	16814M040N	748,66	745,87	-	135	706	54	69	28	44,20
	55	GG	10A	16814M055N	748,66	745,87	-	135	706	70	70	28	48,50
	85	GG	10A	16814M085N	748,66	745,87	-	150	706	102	102	32	60,30
	115	GG	10A	16814M115N	748,66	745,87	-	165	706	133	133	32	75,80
	170	GG	10A	16814M170N	748,66	745,87	-	220	706	187	187	38	125,00
192	40	GG	6A	19214M040N	855,62	852,82	-	135	813	54	69	28	52,20
	55	GG	10A	19214M055N	855,62	852,82	-	135	813	70	70	28	57,80
	85	GG	10A	19214M085N	855,62	852,82	-	165	813	102	102	32	70,20
	115	GG	10A	19214M115N	855,62	852,82	-	165	813	133	133	32	88,30
	170	GG	10A	19214M170N	855,62	852,82	-	220	813	187	187	38	136,40
216	40	GG	6A	21614M040N	962,57	959,76	-	150	920	54	69	28	60,00
	55	GG	10A	21614M055N	962,57	959,76	-	150	920	70	70	28	67,00
	85	GG	10A	21614M085N	962,57	959,76	-	165	920	102	102	32	81,00
	115	GG	10A	21614M115N	962,57	959,76	-	165	920	133	133	32	98,00
	170	GG	10A	21614M170N	962,57	959,76	-	220	920	187	187	38	147,00